



# TECH. SHEET UMF 2011

## VARIABLE DYNAMIC DROP OUT

- Variable drop out with 20 mm adjustment area
- Perfect for singlespeed – integrated chaintensioner
- Variable chainstay length
- No movement possible
- Dropouts are ready for Freddy, Slope und Hardy, with or without hanger

### Uses at:

Freddy Series, Slope Series, Hardy DJ Series

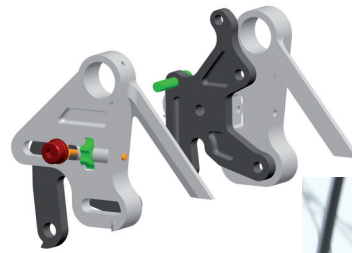

## LOW PROFILE HFS TOP TUBE TOPTUBE

- Reduced the risk of injury by the LowProfile HFS Design
- Optimal Cablelines
- Better transfer of forces from the headtube to the toptube
- Very dynamic shape

### Uses at:

Freddy Series, Slope Series, Hardy DJ Series, Hardy 4X series

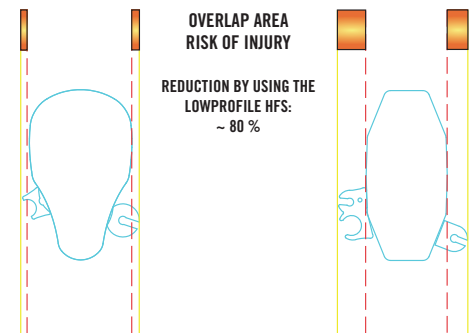

## HFS DOWNTUBE

- HFS tubing improves the structure of Hardy DJ Pro and Slope frame, especially there where you need a higher performance!
- Very dynamic and smooth shape

### Uses at:

Slope Series, Hardy DJ Pro Series

## ISCG 03+05

- Now useable for all Chainguides!
- ISCG-05 allows to use the new generation of BB-Sets with oversized bearings

### Used at:

Freddy Series, Slope Series, Hardy 4X Series



**DUNCAN<sup>2</sup>**

2011 UMF Duncan  
 Chatel, France. 25.6.2010  
 New Worldrecord  
 12h Non-Stop DH  
**27'365 meter of Alltitude**  
 Alban Aubert

**Alban Aubert**

This diagram illustrates the assembly of a motorcycle rear swingarm. It shows the swingarm, shock absorbers, and various mounting hardware. Torque specifications are provided for key fasteners:

- 10-12 Nm:** Green callouts for multiple bolts and nuts, including those on the shock absorbers and swingarm pivots.
- 15-18 Nm:** Purple callouts for the swingarm pivot bolts and the shock absorber mounting bolts.
- 8-10 Nm:** Purple callouts for the swingarm pivot nuts.
- 6-8 Nm:** Red callouts for the shock absorber mounting nuts.
- 5-7 Nm:** Blue callout for the shock absorber mounting bolt.

Other labels include 'LH' (Left Hand), 'R' (Right), 'B' (Bushing), 'W' (Washer), 'LW' (Lock Washer), and 'D' (Disc).



# DUNCAN<sup>2</sup> TEAM



## SPECIFICATIONS

FRAME	2010 Duncan
SIZE	16"
WEIGHT	18,7 kg
FRAMEWEIGHT	4,42kg w/o shock
COLORCODE	white satin (TC2010)
TUBE	PG tube Extraction
PRODUCTION	TIG welding
MATERIAL	Alloy 6061
SPEED	10
DROP-OUT	
SHOCK	Marzocchi Roco RC World Cup
TRAVEL FRONT	220mm
FORK	Marzocchi 888 RC3 EVO
TRAVEL FRONT	200mm
BB SET	Truvativ Howitzer
BRAKE-LEVER	Hayes Stroker Ace
BRAKE-FRONT	Hayes Stroker Ace 203mm
BRAKE-REAR	Hayes Stroker Ace 203mm
CHAIN	SRAM PC-1051
CHAINGUARD	MRP-G2
CHAINWHEEL	Truvativ Holzfeller 1.1 OTC DHG 38T
DERA-FRONT	
DERA-REAR	SRAM X.9 short cage
FREEWHEEL	SRAM PG-1070 11-26
GRIP	Velo VLG-884AD2-2L
H-BAR	Truvativ Boobar 318 L:740 R:20
H-B STEM	Marzocchi
HEAD SET	FSA The Big Flat PiG 1.5"
HUB-FRONT	Alex A-CLASS Revolt
HUB-FRONT AXLE	20mm
HUB-REAR	Alex A-CLASS Revolt
HUB-REAR AXLE	12mm 150mm
WHEELSIZE	26"
PEDAL	
RIM	Alex A-CLASS Revolt
SADDLE	Velo VL-4157
SEAT CLAMP	UMF QR
SEAT POST	Aricle YC-SP-A533
SHIFTER-FRONT	
SHIFTER-REAR	SRAM X.7 SL Trigger 10s
SPOKE	Alex A-CLASS Revolt
TIRE-FRONT	Maxxis Minion Front 2.5 60 42a
TIRE-REAR	Maxxis Minion Rear 2.5 60 42a
OTHER	

## GEOMETRY

FRAME SIZE		16"/M
FRAME LENGTH IN MM	CT	400
FRAME SIZE IN MM	AH	585
TOP TUBE HORIZON IN MM	A	510
SEAT TUBE IN MM	C	165
DROP OUT INNER WIDTH		150
CHAIN STAYS IN MM	D	444
HEAD TUBE ANGLE	Q1	66
SEAT TUBE ANGLE	Q7	60
SEAT TUBE DIAMETER IN MM		31,6
BOTTOM BRACKET DROP IN MM	H	32
BOTTOM BRACKET WIDTH IN MM		83
WHEEL BASE IN MM	W	
FORK OFFSET IN MM	F	44
HEAD TUBE LENGTH IN MM	L	120
STEERER DIAMETER IN INCH		1,5"
FORK LENGTH IN MM	G	580
ISCG		ISCG 03

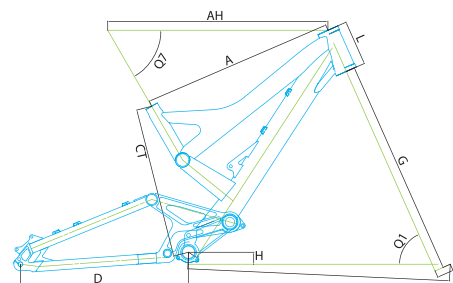

## NEWS BLOG

The 2011 UMF Duncan featuring sensational value and 220 mm suspension travel. Its compact and agile frame within a modified top tube (frame available separately) does not only master mere downhill tracks our Duncan rocks every bike park, too!

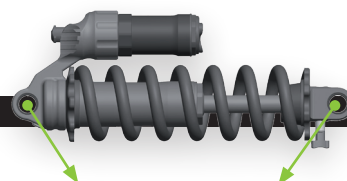

## REAR SHOCK DETAILS

Transmission Ratio: 1:2,89

MODEL	SIZES		BODY EYELET		SHAFT EYELET		SPRING RATE
	in.	mm	PIN width	PIN ID	PIN width	PIN ID	
ROCO RC World Cup w/ Piggyback	9.5 x 3.0"	241.3 x 76.2mm	22,0 mm	8 mm	22,0 mm	8 mm	450

# DUNCAN<sup>2</sup> COMP



DH



## SPECIFICATIONS

FRAME	2010 Duncan
SIZE	16"
WEIGHT	19,8 kg
FRAMEWEIGHT	4,42kg w/o shock
COLORCODE	darksilver (K11J)
TUBE	PG tube Extraction
PRODUCTION	TIG welding
MATERIAL	Alloy 6061
SPEED	9
DROP-OUT	
SHOCK	Marzocchi Roco R w/ Piggyback
TRAVEL FRONT	220mm
FORK	Marzocchi 888 RCV
TRAVEL FRONT	200mm
BB SET	Truvativ Howitzer
BRAKE-LEVER	Tektro Auriga Pro
BRAKE-FRONT	Tektro Auriga Pro 203mm
BRAKE-REAR	Tektro Auriga Pro 203mm
CHAIN	KMC X9
CHAINGUARD	MRP-G2 steel
CHAINWHEEL	Truvativ Hussefelt Single 1.1 38T
DERA-FRONT	
DERA-REAR	SRAM X.7 short cage
FREEWHEEL	SRAM PG-950 11-28
GRIP	Velo VLG-884AD2-2L
H-BAR	MJ 3550 R:25 L:750
H-B STEM	MJ-Raptor
HEAD SET	FSA The Big Flat PiG 1.5"
HUB-FRONT	DH Pro 20mm 36hole
HUB-FRONT AXLE	20mm
HUB-REAR	DH Pro 36hole
HUB-REAR AXLE	12mm 150mm
WHEELSIZE	26"
PEDAL	Wellgo B038
RIM	Alex SupraBH
SADDLE	Velo VL-4157
SEAT CLAMP	UMF QR
SEAT POST	Aricle YC-SP-A533
SHIFTER-FRONT	
SHIFTER-REAR	SRAM X.7 SL Trigger
SPOKE	Stainless red anodized
TIRE-FRONT	Maxxis Minion Front 2.5 60
TIRE-REAR	Maxxis Minion Rear 2.5 60
OTHER	

## GEOMETRY

FRAME SIZE		16"/M
FRAME LENGTH IN MM	CT	400
FRAME SIZE IN MM	AH	585
TOP TUBE HORIZON IN MM	A	510
SEAT TUBE IN MM	C	165
DROP OUT INNER WIDTH		150
CHAIN STAYS IN MM	D	444
HEAD TUBE ANGLE	Q1	66
SEAT TUBE ANGLE	Q7	60
SEAT TUBE DIAMETER IN MM		31,6
BOTTOM BRACKET DROP IN MM	H	32
BOTTOM BRACKET WIDTH IN MM		83
WHEEL BASE IN MM	W	
FORK OFFSET IN MM	F	44
HEAD TUBE LENGTH IN MM	L	120
STEERER DIAMETER IN INCH		1,5"
FORK LENGTH IN MM	G	580
ISCG		ISCG 03

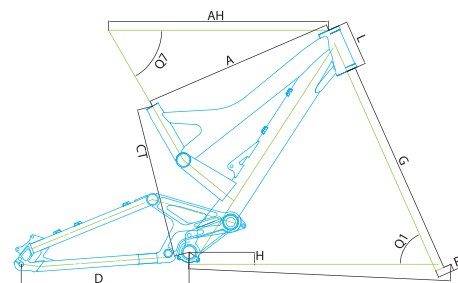

## NEWS BLOG

The 2011 UMF Duncan featuring sensational value and 220 mm suspension travel. Its compact and agile frame within a modified top tube (frame available separately) does not only master mere downhill tracks our Duncan rocks every bike park, too!

## REAR SHOCK DETAILS

Transmission Ratio: 1:2,89

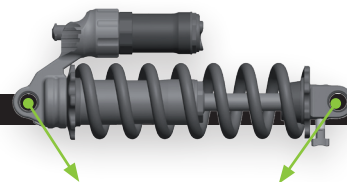

MODEL	SIZES		BODY EYELET		SHAFT EYELET		SPRING RATE
	in.	mm	PIN width	PIN ID	PIN width	PIN ID	
ROCO R w/ Piggyback	9.5 x 3.0"	241.3 x 76.2mm	22,0 mm	8 mm	22,0 mm	8 mm	450



## SAG REARTRAVEL

<b>Freddy:</b>	<b>Adv. Sag in %</b>
<b>Slopestyle:</b>	<b>10-15%</b>
<b>Bikepark with "big Drops":</b>	<b>20-25%</b>
<b>Freeride:</b>	<b>25-35%</b>
<b>Duncan:</b>	<b>Adv. Sag in %</b>
<b>Bikepark with "big Drops":</b>	<b>20-30%</b>
<b>Speed DH with "medium Drops":</b>	<b>25-30%</b>
<b>Technischer DH with many small/middle "Humps"</b>	<b>30-40%</b>
<b>Slope</b>	<b>Adv. Sag in %</b>
<b>Slopestyle:</b>	<b>5-12%</b>
<b>Bikepark with "big Drops":</b>	<b>12-20%</b>

## Usage hints for suspension fork pumps:

Usage hints for suspension fork pumps:

The following hints will help you to use suspension fork pumps optimally while increasing their lifetime.

1. The hints apply to suspension fork pumps as well as to air shocks. Please do not screw the pump hose onto the valve as far as it will go. Otherwise, the pump gasket might be damaged.
2. While fixing the hose, please observe the pump's pressure gauge. Screw the hose onto the valve until some pressure is indicated (plus max. another ¼ to ½ turn).
3. Demounting the pump always causes slight pressure loss. By using our hints above, pressure loss will remain as low as 5 %. Thus, please add these 5 % to your individual pressure value desired for optimal performance.



## FORK - SPRINGKIT MARZOCCHI

MODEL		FORK TRAVEL (MM)	STANDARD SPRINGS		SOFT SPRING KIT				HEAVY SPRING KIT				EXTRA HEAVY SPRING KIT			
			SPRING RATE	SPRING	SPRING KIT	SPRING RATE	SPRING GUIDE	SPRING	SPRING KIT	SPRING RATE	SPRING GUIDE	SPRING	SPRING KIT	SPRING RATE	SPRING GUIDE	SPRING
<b>55</b>	<b>55 RC3 TITANIUM</b>	<b>160</b>	1-SIDE TITANIUM K=7,3	5141930	8501473	1-SIDE TITANIUM K=6	536185	5141949 RED - BETA C TITANIUM		NA				NA		
	<b>55 RV</b>	<b>160</b>	"DOUBLE COIL K=3,7 X 2"	5141914		NA				"DOUBLE COIL K=5 X 2"		5141951 X 2 -GREEN - 55CRS16		NA		
<b>66</b>	<b>66 RC3 TITANIUM</b>	<b>180</b>	1-SIDE TITANIUM K=5,4	5141928	8501476	1-SIDE TITANIUM K=4,4	536186	5141952 RED - BETA C TITANIUM	8501477	1-SIDE TITANIUM K=6,5	536193	5141953 BLUE - BETA C TITANIUM		NA		
	<b>66 RC-3 66 RCV</b>	<b>180</b>	"1-SIDE: COIL K=5,4"	5141863		1-SIDE: COIL K=4,4	NO SPRING GUIDE NEEDED	5141954 BROWN - 55CRS16		1-SIDE: COIL K 6.5	NO SPRING GUIDE NEEDED	5141955 -GREEN - 55CRS16		NA		
<b>888</b>	<b>888 RC-3 EVO TITANIUM</b>	<b>200</b>	1-SIDE TITANIUM K=5,5	5141918	8501480	1-SIDE TITANIUM K=4,4	536188	5141956 RED - BETA C TITANIUM	8501481	1-SIDE TITANIUM K=6,5	536195	5141957 BLUE - BETA C TITANIUM	8501482	1-SIDE TITANIUM K=7,7	536198	5141958 GREY - BETA C TITANIUM
	<b>888 RC-3 EVO 888 RCV</b>	<b>200</b>	"1-SIDE: COIL K=5,4"	5141923		1-SIDE: COIL K=4,4	NO SPRING GUIDE NEEDED	5141959 BROWN - 55CRS16		1-SIDE: COIL K=6,5	NO SPRING GUIDE NEEDED	5141960 -GREEN - 55CRS16		1-SIDE: COIL K=7,7	NO SPRING GUIDE NEEDED	5141961 GREY - 55CRS16





## FREDDY SERVICE

2011 NM

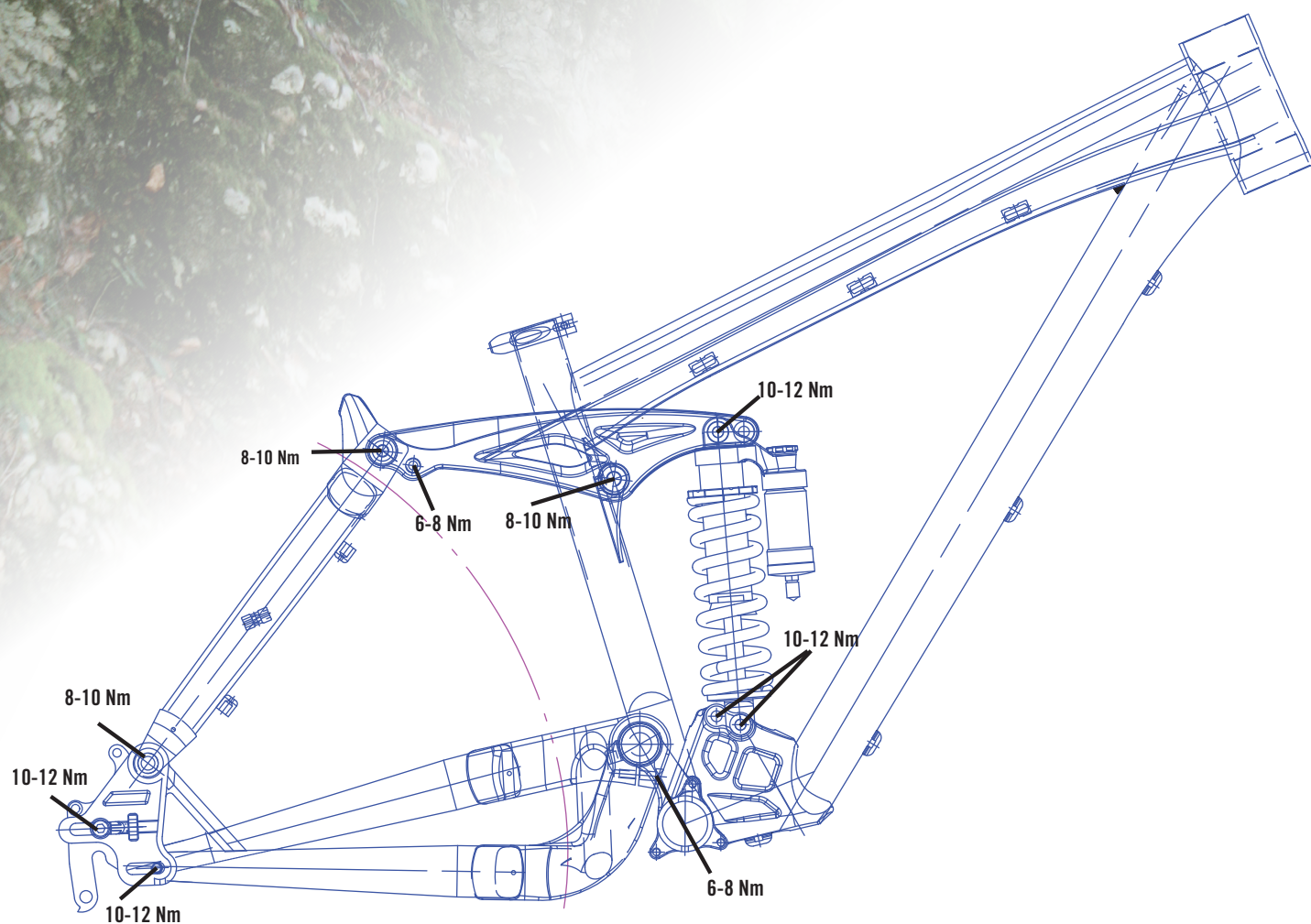



# FREDDY TEAM



Bikepark



## SPECIFICATIONS

FRAME	2010 Freddy
SIZE	15"-17"
WEIGHT	17,3 kg
FRAMEWEIGHT	4,1 kg w/o shock
COLORCODE	teamgreen (G21Y)
TUBE	Low Profile HFS
PRODUCTION	TIG welding
MATERIAL	Alloy 6061
SPEED	10
DROP-OUT	Variable Dynamic Dropout
SHOCK	Marzocchi Air RC World Cup
TRAVEL FRONT	170mm
FORK	Marzocchi 66 RC3 EVO 1.5 - 1-1/8"
TRAVEL FRONT	180mm
BB SET	Truvativ Howitzer
BRAKE-LEVER	Hayes Stroker Ace
BRAKE-FRONT	Hayes Stroker Ace 203mm
BRAKE-REAR	Hayes Stroker Ace 203mm
CHAIN	SRAM PC-1051
CHAINGUARD	MRP-G2
CHAINWHEEL	Truvativ Holzfeller OTC 1.1 36T
DERA-FRONT	
DERA-REAR	SRAM X.9 short cage
FREEWHEEL	SRAM PG-1070 11-26
GRIP	Velo VLG-884AD2-2L
H-BAR	Truvativ Holzfeller 31.8D R20
H-B STEM	MJ Raptor-1 L:45
HEAD SET	FSA Gravity SX(I/E) 1.5-1-1/8"
HUB-FRONT	DH Pro 20mm 32hole
HUB-FRONT AXLE	20mm
HUB-REAR	DH Pro 32hole
HUB-REAR AXLE	10mm Quickrelase
WHEELSIZE	26"
PEDAL	Wellgo B065
RIM	Alex Supra30
SADDLE	Velo VL-2064 CM
SEAT CLAMP	UMF QR
SEAT POST	Aricle YC-SP-A533
SHIFTER-FRONT	
SHIFTER-REAR	SRAM X.7 SL Trigger
SPOKE	PSR14
TIRE-FRONT	Maxxis Minion Front 2.5 60
TIRE-REAR	Maxxis Minion Rear 2.5 60
OTHER	

## GEOMETRY

FRAME SIZE		15"/M	17"/L
FRAME LENGTH IN MM	CT	381	440
FRAME SIZE IN MM	AH	565	595
TOP TUBE HORIZON IN MM	A	553	580
SEAT TUBE IN MM	C	310	400
DROP OUT INNER WIDTH		135	135
CHAIN STAYS IN MM	D	432+/-10	432+/-10
HEAD TUBE ANGLE	Q1	66,5	66,5
SEAT TUBE ANGLE	Q7	73	73
SEAT TUBE DIAMETER IN MM		31,6	31,6
BOTTOM BRACKET DROP IN MM	H	25	25
BOTTOM BRACKET WIDTH IN MM		73	73
WHEEL BASE IN MM	W	1124+/-10	1154+/-10
FORK OFFSET IN MM	F	44,5	44,5
HEAD TUBE LENGTH IN MM	L	120	120
STEERER DIAMETER IN INCH		1 1/8- 1,5"	1 1/8- 1,5"
FORK LENGTH IN MM	G	541,5	541,5
ISCG		ISCG 03+05	ISCG 03+05

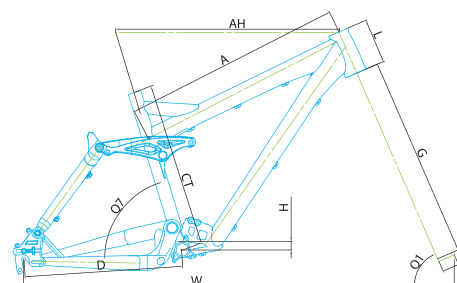

## NEWS BLOG

The Freddy Team, still be considered as a kind of classic, for 2011 with many new features. Find beside the Low Profile Top tube and the Variable Dynamic Drop Out a tapered steerer. Its extreme agility makes this model an ideal companion for all bike park adventures, especially with the new option to adjust your personal chain stay length! Because of this playground all 2011 Freddys have a single chainwheel in the front only

## REAR SHOCK DETAILS

Transmission Ratio: 1:2,68

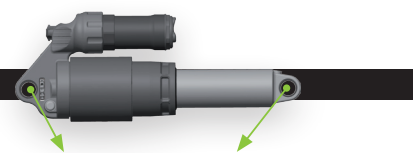

MODEL	SIZES		BODY EYELET		SHAFT EYELET	
	in.	mm	PIN width	PIN ID	PIN width	PIN ID
ROCO AIR RC World Cup w/ Piggyback	8.5 x 2.5"	215.5 x 63.5mm	40 mm	8 mm	35 mm	8 mm

# FREDDY 1



Bikepark



## SPECIFICATIONS

FRAME	2010 Freddy
SIZE	15"-17"
WEIGHT	17,8 kg
FRAMEWEIGHT	4,1 kg w/o shock
COLORCODE	silver (A4Y)
TUBE	Low Profile HFS
PRODUCTION	TIG welding
MATERIAL	Alloy 6061
GO	9
DROP-OUT	Variable Dynamic Dropout
SHOCK	Marzocchi Roco Air R
TRAVEL FRONT	170mm
FORK	Marzocchi 66RCV 1.5"-1-1/8"
TRAVEL FRONT	180mm
BB SET	Truvativ Howitzer
BRAKE-LEVER	attached
BRAKE-FRONT	Hayes Stroker Trail, 203mm
BRAKE-REAR	Hayes Stroker Trail, 203mm
CHAIN	KMC X9
CHAINGUARD	MRP-G2 Steel
CHAINWHEEL	Truvativ Hussefelt 1.0 36T
DERA-FRONT	
DERA-REAR	SRAM X.7 short cage
FREEWHEEL	SRAM PG-950 11-32
GRIP	Velo VLG-775AD2-2L
H-BAR	Truvativ Hussefelt R:20
H-B STEM	Truvativ Hussefelt L:40
HEAD SET	FSA Gravity SX(I/E) 1.5-1-1/8"
HUB-FRONT	DH Pro 20mm 36hole
HUB-FRONT AXLE	20mm
HUB-REAR	DH Pro 36hole
HUB-REAR AXLE	10mm Quickrelase
WHEELSIZE	26"
PEDAL	DH Comp bearing
RIM	Alex SupraBH
SADDLE	Velo VL-2064 CM
SEAT CLAMP	UMF QR
SEAT POST	MJ MSP-15
SHIFTER-FRONT	
SHIFTER-REAR	SRAM X.7 SL Trigger
SPOKE	Stainless red anodized
TIRE-FRONT	Maxxis Minion Front 2.5 60
TIRE-REAR	Maxxis Minion Rear 2.5 60
OTHER	

## GEOMETRY

FRAME SIZE		15"/M	17"/L
FRAME LENGTH IN MM	CT	381	440
FRAME SIZE IN MM	AH	565	595
TOP TUBE HORIZON IN MM	A	553	580
SEAT TUBE IN MM	C	310	400
DROP OUT INNER WIDTH		135	135
CHAIN STAYS IN MM	D	432+/-10	432+/-10
HEAD TUBE ANGLE	Q1	66,5	66,5
SEAT TUBE ANGLE	Q7	73	73
SEAT TUBE DIAMETER IN MM		31,6	31,6
BOTTOM BRACKET DROP IN MM	H	25	25
BOTTOM BRACKET WIDTH IN MM		73	73
WHEEL BASE IN MM	W	1124+/-10	1154+/-10
FORK OFFSET IN MM	F	44,5	44,5
HEAD TUBE LENGTH IN MM	L	120	120
STEERER DIAMETER IN INCH		1 1/8- 1,5"	1 1/8- 1,5"
FORK LENGTH IN MM	G	541,5	541,5
ISCG		ISCG 03+05	ISCG 03+05

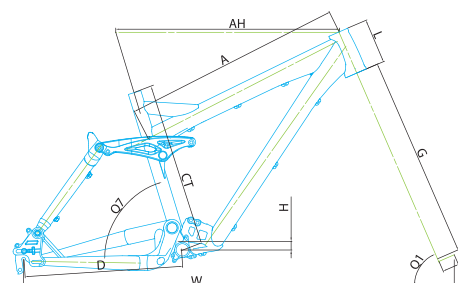

## NEWS BLOG

Featuring the same frame of our namesake Team model, this Freddy is also equipped with a single crown fork, 1 1/8 to 1,5 steerer and air rear shock – the bike park is calling for you! Because of this playground all 2011 Freddys have a single chainwheel in the front only.

## REAR SHOCK DETAILS

Transmission Ratio: 1:2,68



MODEL	SIZES	BODY EYELET	SHAFT EYELET
	in. mm	PIN width PIN ID	PIN width PIN ID
ROCO Air R w/ Piggyback	8.5 x 2.5" 215.5 x 63.5mm	40 mm 8 mm	35 mm 8 mm



# FREDDY 2



Bikepark



## SPECIFICATIONS

FRAME	2010 Freddy
SIZE	15-17
WEIGHT	18,2 kg
FRAMEWEIGHT	4,1 kg w/o shock
COLORCODE	black (P12V)
TUBE	Low Profile HFS
PRODUCTION	TIG welding
MATERIAL	Alloy 6061
60	9
DROP-OUT	Variable Dynamic Dropout
SHOCK	Marzocchi Roco R
TRAVEL FRONT	170mm
FORK	Marzocchi 55 RV 1.5"-1-1/8" 20mm
TRAVEL FRONT	160mm
BB SET	Truvativ Howitzer
BRAKE-LEVER	attached
BRAKE-FRONT	Tektro Auriga Pro, 203mm
BRAKE-REAR	Tektro Auriga Pro, 203mm
CHAIN	KMC X9
CHAINGUARD	MRP-G2 Steel
CHAINWHEEL	Truvativ Ruktion 1.0 36T
DERA-FRONT	
DERA-REAR	SRAM X.5 Medium
FREEWHEEL	SRAM PG-950 11-32T
GRIP	Velo VLG-539AD2-2L
H-BAR	UMF OV RISE
H-B STEM	UMF OV L:50
HEAD SET	FSA Gravity SK(I/E) 1.5-1-1/8"
HUB-FRONT	DH Pro 20mm 36H
HUB-FRONT AXLE	20mm
HUB-REAR	Disc Alloy 10mm Axle
HUB-REAR AXLE	10mm Quickrelase
WHEELSIZE	26"
PEDAL	DH Comp bearing
RIM	Alex SupraFRX
SADDLE	Velo VL-2051
SEAT CLAMP	UMF QR
SEAT POST	MJ MSP-15
SHIFTER-FRONT	
SHIFTER-REAR	SRAM X.5 Trigger
SPOKE	Stainless 2.0
TIRE-FRONT	Maxxis High Roller 2.35 60
TIRE-REAR	Maxxis High Roller 2.35 60
OTHER	

## GEOMETRY

FRAME SIZE		15"/M	17"/L
FRAME LENGTH IN MM	CT	381	440
FRAME SIZE IN MM	AH	565	595
TOP TUBE HORIZON IN MM	A	553	580
SEAT TUBE IN MM	C	310	400
DROP OUT INNER WIDTH		135	135
CHAIN STAYS IN MM	D	432+/-10	432+/-10
HEAD TUBE ANGLE	Q1	66,5	66,5
SEAT TUBE ANGLE	Q7	73	73
SEAT TUBE DIAMETER IN MM		31,6	31,6
BOTTOM BRACKET DROP IN MM	H	25	25
BOTTOM BRACKET WIDTH IN MM		73	73
WHEEL BASE IN MM	W	1124+/-10	1154+/-10
FORK OFFSET IN MM	F	44,5	44,5
HEAD TUBE LENGTH IN MM	L	120	120
STEERER DIAMETER IN INCH		1 1/8- 1,5"	1 1/8- 1,5"
FORK LENGTH IN MM	G	541,5	541,5
ISCG		ISCG 03+05	ISCG 03+05

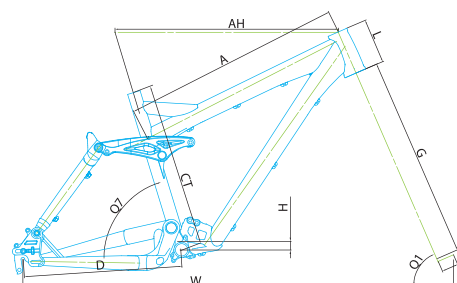

## NEWS BLOG

Still the sturdy starter model par excellence thanks to concentration on all essential elements. Frame, fork, cranks and wheel set are designed for full bike park fun at an extremely economical price! You will find also the hydro formed Low Profile Top Tube, tapered steerer and the Dynamic Variable Drop Out! Because of this playground all 2011 Freddy's have a single chainwheel in the front only

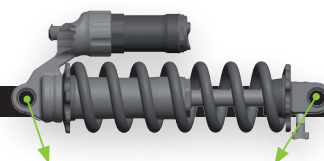

## REAR SHOCK DETAILS

Transmission Ratio: 1:2,68

MODEL	SIZES	BODY EYELET	SHAFT EYELET	SPRING RATE
	in.	mm	PIN ID	PIN ID
ROCO R w/ Piggyback	8.5 x 2.5"	215.5 x 63.5mm	40mm	8mm
			PIN width	PIN ID
			PIN width	PIN ID
				15°: 400
				17°: 450°



# SLOPE TEAM



## SPECIFICATIONS

FRAME	2011 new Slope frame
SIZE	M/L
WEIGHT	14,8 kg
FRAMEWEIGHT	3,38 kg w/o shock
COLORCODE	teamgreen (G21Y)
TUBE	Low Profile HFS
PRODUCTION	TIG welding
MATERIAL	Alloy 6061
GO	10
DROP-OUT	Variable Dynamic Dropout
SHOCK	Marzocchi ROCO LO Air in-line
TRAVEL FRONT	130mm
FORK	Marzocchi 55 RV 140mm 1.5"-1-1/8"
TRAVEL FRONT	140mm
BB SET	Truvativ Howitzer
BRAKE-LEVER	Hayes Stroker Prime
BRAKE-FRONT	Hayes Stroker Prime Expert 180mm
BRAKE-REAR	Hayes Stroker Prime Expert 180mm
CHAIN	SRAM PC-1051
CHAINGUARD	MRP-Mini G2
CHAINWHEEL	Truvativ Holzfeller OTC 1.1 34T
DERA-FRONT	
DERA-REAR	SRAM X.9 short cage
FREEWHEEL	SRAM PG-1070 11-28
GRIP	Velo VLG-884AD2-2L
H-BAR	Truvativ Holzfeller R:20
H-B STEM	Truvativ Holzfeller L:40
HEAD SET	FSA Gravity SX(I/E) 1.5-1-1/8"
HUB-FRONT	DH Pro 20mm 32hole
HUB-FRONT AXLE	20mm
HUB-REAR	DH Pro 32hole
HUB-REAR AXLE	10mm Quickrelase
WHEELSIZE	26"
PEDAL	DH Pro bearing
RIM	Alex Supra30
SADDLE	Velo VL-7046
SEAT CLAMP	UMF QR
SEAT POST	Premetec Pivotal
SHIFTER-FRONT	
SHIFTER-REAR	SRAM X.7 SL Trigger
SPOKE	PSR14
TIRE-FRONT	Maxxis Larsen TT 2.35 60 KV
TIRE-REAR	Maxxis Larsen TT 2.35 60 KV
OTHER	

## GEOMETRY

FRAME SIZE		S/M	M/L
FRAME LENGTH IN MM	CT	360	360
FRAME SIZE IN MM	AH	554	585
TOP TUBE HORIZON IN MM	A	530	558
SEAT TUBE IN MM	C	158	158
DROP OUT INNER WIDTH		135	135
CHAIN STAYS IN MM	D	425+/-10	425+/-10
HEAD TUBE ANGLE	Q1	68,5	68,5
SEAT TUBE ANGLE	Q7	70	70
SEAT TUBE DIAMETER IN MM		31,6	31,6
BOTTOM BRACKET DROP IN MM	H	10	10
BOTTOM BRACKET WIDTH IN MM		73	73
WHEEL BASE IN MM	W	1097+/-10	1128+/-10
FORK OFFSET IN MM	F	44	44
HEAD TUBE LENGTH IN MM	L	115	115
STEERER DIAMETER IN INCH		1 1/8- 1,5"	1 1/8- 1,5"
FORK LENGTH IN MM	G	533	533
ISCG		03+05	03+05

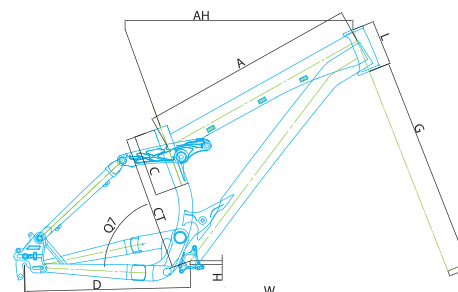

## NEWS BLOG

Brand-new bike for fabulously fat lines!

Rear: 130 mm (Marzocchi Roco Air LO), front: 140 mm (Marzocchi 55 Series)

HFS frame with Tapered Steerer (1.5"-1-1/8"), LOW PROFILE HFS TOP TUBE and

Variable Dynamic Drop Out

MRP Mini G2 chain guide

Nearly degressive characteristic for lowest possible interference during jumping

Available in two lengths

## REAR SHOCK DETAILS

Transmission Ratio: 1:2,65

MODEL	SIZES		BODY EYELET		SHAFT EYELET	
	in.	mm	PIN width	PIN ID	PIN width	PIN ID
ROCO AIR LO	8.5 x 2.5"	190.5 x 50,0mm	30 mm	8 mm	22,2 mm	8 mm

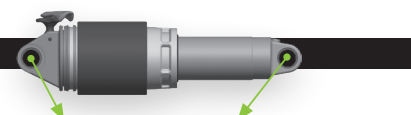

# SLOPE 1



## SPECIFICATIONS

FRAME	2011 new Slope frame
SIZE	M/L
WEIGHT	15,2 kg
FRAMEWEIGHT	3,38 kg w/o shock
COLORCODE	grey (M45V)
TUBE	Low Profile HFS
PRODUCTION	TIG welding
MATERIAL	Alloy 6061
60	9
DROP-OUT	Variable Dynamic Dropout
SHOCK	Marzocchi ROCO LO Air in-line
TRAVEL FRONT	130mm
FORK	Marzocchi 55 RS 140mm 1.5"-1-1/8"
TRAVEL FRONT	140mm
BB SET	Truvativ Howitzer
BRAKE-LEVER	Tektro Auriga Pro
BRAKE-FRONT	Tektro Auriga Pro 180mm
BRAKE-REAR	Tektro Auriga Pro 180mm
CHAIN	KMC X9
CHAINGUARD	MRP-Mini G2 Steel
CHAINWHEEL	Truvativ Ruktion 1.0 36T
DERA-FRONT	
DERA-REAR	SRAM X.7 short cage
FREEWHEEL	SRAM PG-950 11-28
GRIP	Velo VLG-775AD2-2L
H-BAR	Truvativ Hussefelt R:30
H-B STEM	MJ Raptor-1 L:45
HEAD SET	FSA Gravity SX(I/E) 1.5-1-1/8"
HUB-FRONT	DH Comp 32hole
HUB-FRONT AXLE	20mm
HUB-REAR	Disc Alloy
HUB-REAR AXLE	10mm Quickrelase
WHEELSIZE	26"
PEDAL	DH Comp bearing
RIM	Alex SupraBH
SADDLE	Velo VL-7046
SEAT CLAMP	UMF QR
SEAT POST	Premetec Pivotal
SHIFTER-FRONT	
SHIFTER-REAR	SRAM X.7 SL Trigger
SPOKE	PSR14
TIRE-FRONT	Maxxis Larsen TT 2.35 60 KV
TIRE-REAR	Maxxis Larsen TT 2.35 60 KV
OTHER	

## GEOMETRY

FRAME SIZE		S/M	M/L
FRAME LENGTH IN MM	CT	360	360
FRAME SIZE IN MM	AH	554	585
TOP TUBE HORIZON IN MM	A	530	558
SEAT TUBE IN MM	C	158	158
DROP OUT INNER WIDTH		135	135
CHAIN STAYS IN MM	D	425+/-10	425+/-10
HEAD TUBE ANGLE	Q1	68,5	68,5
SEAT TUBE ANGLE	Q7	70	70
SEAT TUBE DIAMETER IN MM		31,6	31,6
BOTTOM BRACKET DROP IN MM	H	10	10
BOTTOM BRACKET WIDTH IN MM		73	73
WHEEL BASE IN MM	W	1097+/-10	1128+/-10
FORK OFFSET IN MM	F	44	44
HEAD TUBE LENGTH IN MM	L	115	115
STEERER DIAMETER IN INCH		1 1/8- 1,5"	1 1/8- 1,5"
FORK LENGTH IN MM	G	533	533
ISCG		03+05	03+05

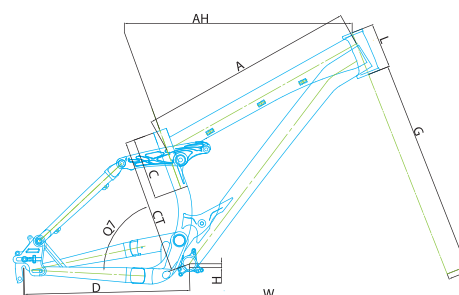

## NEWS BLOG

Brand-new bike for fabulously fat lines!

Rear: 130 mm (Marzocchi Roco Air LO), front: 140 mm (Marzocchi 55 Series)

HFS frame with Tapered Steerer (1.5"-1-1/8"), LOW PROFILE HFS TOP TUBE and Variable Dynamic Drop Out

MRP Mini G2 chain guide

Nearly degressive characteristic for lowest possible interference during jumping

Available in two lengths

## REAR SHOCK DETAILS

Transmission Ratio: 1:2,65

MODEL	SIZES		BODY EYELET		SHAFT EYELET	
	in.	mm	PIN width	PIN ID	PIN width	PIN ID
ROCO AIR LO	8.5 x 2.5"	190.5 x 50,0mm	30 mm	8 mm	22,2 mm	8 mm

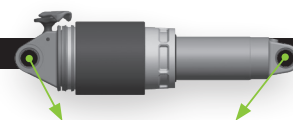



# HARDY DJ TEAM



## SPECIFICATIONS

FRAME	2011 Hardy DJ Pro Disc
SIZE	S/M
WEIGHT	11,4 kg
FRAMEWEIGHT	2,29 kg
COLORCODE	perlmutwhite (P13Z)
TUBE	Low Profile HFS
PRODUCTION	TIG welding
MATERIAL	Alloy 6061
GO	Single speed
DROP-OUT	Variable Dynamic Dropout
SHOCK	
TRAVEL FRONT	
FORK	Marzocchi Dirt Jumper 1 1.5"-1-1/8"
TRAVEL FRONT	100 mm
BB SET	Samox EBA-48 EuroBB
BRAKE-LEVER	Right: Hayes
BRAKE-FRONT	mech. Disc (not att.)
BRAKE-REAR	Hayes Stroker Trail, 160mm
CHAIN	KMC K710SL
CHAINGUARD	
CHAINWHEEL	Samox BFC-1818 & CW-1416M 25T
DERA-FRONT	
DERA-REAR	
FREEWHEEL	10T
GRIP	Velo VLG-884AD2-2L Double Clamp
H-BAR	Truvativ Holzfeller R:20
H-B STEM	MJ Raptor-1 L:45
HEAD SET	FSA Gravity SX(I/E) 1.5-1-1/8"
HUB-FRONT	DH Pro 32 hole
HUB-FRONT AXLE	20 mm
HUB-REAR	Jump Pro 32 hole
HUB-REAR AXLE	10 mm Quickrelease
WHEELSIZE	26"
PEDAL	Wellgo B065
RIM	Alex SUPRA 30
SADDLE	Velo VL-7046
SEAT CLAMP	UMF QR
SEAT POST	Premetec Pivotal 31.6mm
SHIFTER-FRONT	
SHIFTER-REAR	
SPOKE	PSR14
TIRE-FRONT	Maxxis DTH 2.15 FW120 60aMP
TIRE-REAR	Maxxis DTH 2.15 FW120 60aMP
OTHER	

## GEOMETRY

FRAME SIZE		S	M
FRAME LENGTH IN MM	CT	325	325
FRAME SIZE IN MM	AH	560	585
TOP TUBE HORIZON IN MM	A	550	574
SEAT TUBE IN MM	C	269	269
DROP OUT INNER WIDTH		135	135
CHAIN STAYS IN MM	D	408+/-10	408+/-10
HEAD TUBE ANGLE	Q1	70	70
SEAT TUBE ANGLE	Q7	72	72
SEAT TUBE DIAMETER IN MM		31,6	31,6
BOTTOM BRACKET DROP IN MM	H	15	22
BOTTOM BRACKET WIDTH IN MM		73	73
WHEEL BASE IN MM	W	1035+/-10	1058+/-10
FORK OFFSET IN MM	F	48	48
HEAD TUBE LENGTH IN MM	L	115	115
STEERER DIAMETER IN INCH		1 1/8"-1,5"	1 1/8"-1,5"
FORK LENGTH IN MM	G	481	481
ISCG		no	no

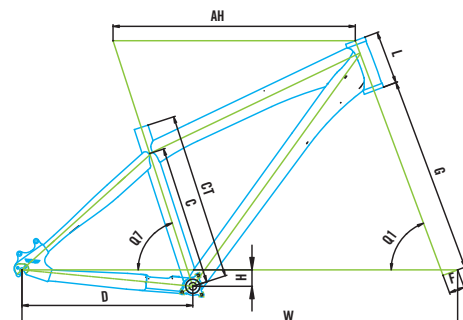

## NEWS BLOG

**Brand-new HFS frame in two lengths**  
**HFS frame with TAPERED STEERER (1.5"-1-1/8"), LOW PROFILE HFS TOP TUBE**  
**and VARIABLE DYNAMIC DROP OUT**  
**New down tube and seat stay for improved distribution of influent physical forces**  
**BMX cranks**  
**Pivotal saddle**



# HARDY DJ 1



## SPECIFICATIONS

FRAME	2011 Hardy DJ Pro Disc
SIZE	S/M
WEIGHT	12,1 kg
FRAMEWEIGHT	2,29 kg
COLORCODE	black-purple (TC-695)
TUBE	Low Profile HFS
PRODUCTION	TIG welding
MATERIAL	Alloy 6061
GO	Single speed
DROP-OUT	Variable Dynamic Dropout
SHOCK	
TRAVEL FRONT	
FORK	Marzocchi Dirt Jumper 3 1.5"-1-1/8"
TRAVEL FRONT	100 mm
BB SET	Samox EBA-48 Euro Type
BRAKE-LEVER	Right: Tekro Auriga Pro
BRAKE-FRONT	mech. Disc (not att.)
BRAKE-REAR	Tekro Auriga Pro, 160mm
CHAIN	KMC Z610HX
CHAINGUARD	
CHAINWHEEL	Samox BFC-1818 & CW-1416M 25T
DERA.-FRONT	
DERA.-REAR	
FREEWHEEL	10T
GRIP	Velo VLG-884AD2-2L Double Clamp
H-BAR	Truvativ Hussefelt R:20
H-B STEM	Truvativ Hussefelt L:40
HEAD SET	FSA Gravity SX(I/E) 1.5-1-1/8"
HUB-FRONT	DH Pro 32 hole
HUB-FRONT AXLE	20mm
HUB-REAR	Jump disc 32 hole
HUB-REAR AXLE	10 mm Quickrelase
WHEELSIZE	26"
PEDAL	Wellgo B038
RIM	Alex SUPRA BH
SADDLE	Velo VL-7046
SEAT CLAMP	UMF QR
SEAT POST	Premetec Pivotal 31.6mm
SHIFTER-FRONT	
SHIFTER-REAR	
SPOKE	Stainless 2.0
TIRE-FRONT	Maxxis DTH 2.15 FW60 60aMP
TIRE-REAR	Maxxis DTH 2.15 FW60 60aMP
OTHER	

## GEOMETRY

FRAME SIZE		S	M
FRAME LENGTH IN MM	CT	325	325
FRAME SIZE IN MM	AH	560	585
TOP TUBE HORIZON IN MM	A	550	574
SEAT TUBE IN MM	C	269	269
DROP OUT INNER WIDTH		135	135
CHAIN STAYS IN MM	D	408+/-10	408+/-10
HEAD TUBE ANGLE	Q1	70	70
SEAT TUBE ANGLE	Q7	72	72
SEAT TUBE DIAMETER IN MM		31,6	31,6
BOTTOM BRACKET DROP IN MM	H	15	22
BOTTOM BRACKET WIDTH IN MM		73	73
WHEEL BASE IN MM	W	1035+/-10	1058+/-10
FORK OFFSET IN MM	F	48	48
HEAD TUBE LENGTH IN MM	L	115	115
STEERER DIAMETER IN INCH		1 1/8"-1,5"	1 1/8"-1,5"
FORK LENGTH IN MM	G	481	481
ISCG		no	no

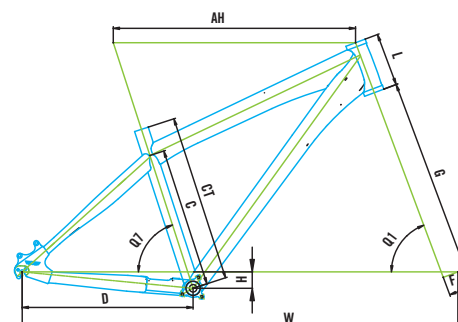

## NEWS BLOG

Brand-new HFS frame in two lengths  
HFS frame with TAPERED STEERER (1.5"-1-1/8"), LOW PROFILE HFS TOP TUBE  
and VARIABLE DYNAMIC DROP OUT  
New down tube and seat stay for improved distribution of influent physical forces  
BMX cranks  
Pivotal saddle



# HARDY DJ 2 24" & 26"



## SPECIFICATIONS

FRAME	2011 Hardy DJ Comp Disc
SIZE	S/M
WEIGHT	13,4 kg
FRAMEWEIGHT	2,4 kg
COLORCODE	"1. brown (M34X) 2. white (P132)"
TUBE	Low Profile HFS
PRODUCTION	TIG welding
MATERIAL	Alloy 6061
60	Single speed
DROP-OUT	Variable Dynamic Dropout
SHOCK	
TRAVEL FRONT	
FORK	Marzocchi DJ Comp
TRAVEL FRONT	100 mm
BB SET	Samox AX02-EBS-4
BRAKE-LEVER	Right: Tekro Auriga Comp
BRAKE-FRONT	mech. Disc (not att.)
BRAKE-REAR	Tekro Auriga Comp, 160mm
CHAIN	KMC Z610HX
CHAINGUARD	
CHAINWHEEL	Samox BFC-21S+CW-1329M 25T
DERA-FRONT	
DERA-REAR	
FREEWHEEL	10T
GRIP	Velo VLG-539AD2
H-BAR	UMF OV R:30
H-B STEM	UMF OV 50 31.8
HEAD SET	FSA No.10
HUB-FRONT	Disc Alloy 32 hole
HUB-FRONT AXLE	5 mm Quickrelase
HUB-REAR	Jump disc NT 32H
HUB-REAR AXLE	5 mm Quickrelase
WHEELSIZE	26" and 24"
PEDAL	BMX Screw pin 9/16
RIM	Alex DM24 26"
SADDLE	Velo VL-7083
SEAT CLAMP	UMF QR
SEAT POST	MJ MSP-15AL.1 31.6D*350L
SHIFTER-FRONT	
SHIFTER-REAR	
SPOKE	Stainless 2.0
TIRE-FRONT	CST C-1381 2.4 27 TPI
TIRE-REAR	CST C-1381 2.4 27 TPI
OTHER	

## GEOMETRY

FRAME SIZE		S	M
FRAME LENGTH IN MM	CT	325	325
FRAME SIZE IN MM	AH	550	585
TOP TUBE HORIZON IN MM	A	542	574
SEAT TUBE IN MM	C	269	269
DROP OUT INNER WIDTH		135	135
CHAIN STAYS IN MM	D	408+/-10	408+/-10
HEAD TUBE ANGLE	Q1	69,5	70
SEAT TUBE ANGLE	Q7	72	72
SEAT TUBE DIAMETER IN MM		31,6	31,6
BOTTOM BRACKET DROP IN MM	H	15	22
BOTTOM BRACKET WIDTH IN MM		73	73
WHEEL BASE IN MM	W	1031+/-10	1058+/-10
FORK OFFSET IN MM	F	48	48
HEAD TUBE LENGTH IN MM	L	115	115
STEERER DIAMETER IN INCH		1 1/8"	1 1/8"
FORK LENGTH IN MM	G	481	481
ISCG		no	no

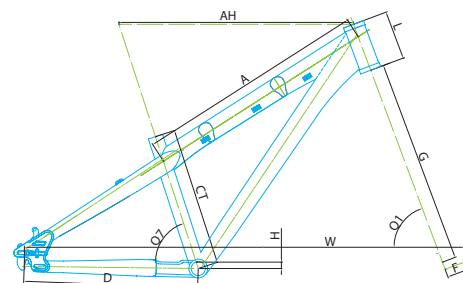

## NEWS BLOG

**Brand-new HFS frame in two lengths and VARIABLE DYNAMIC DROP OUT**  
**New seat stay for improved distribution of influent physical forces**  
**BMX cranks**  
**Pivotal saddle**

# HARDY STEEL TEAM



## SPECIFICATIONS

FRAME	2011 Hardy Steel pro
SIZE	13"
WEIGHT	11,7 kg
FRAMEWEIGHT	2,58 kg
COLORCODE	black-colored (M38E)
TUBE	seamless DB tube
PRODUCTION	welded
MATERIAL	Full Cr-Mo
GO	Single speed
DROP-OUT	
SHOCK	
TRAVEL FRONT	
FORK	Marzocchi Dirt Jumper 1
TRAVEL FRONT	100mm
BB SET	Samox EBA-48 Euro Type
BRAKE-LEVER	Right: Hayes Stroker Trail
BRAKE-FRONT	mech. Disc (not att.)
BRAKE-REAR	Hayes Stroker Trail, 160mm
CHAIN	KMC K710SL
CHAINGUARD	
CHAINWHEEL	Samox BFC-1818 & CW-1416M 25T
DERA-FRONT	
DERA-REAR	
FREEWHEEL	10T
GRIP	Velo VLG-808AD2-2L
H-BAR	MJ-203CR R:38 CrMo
H-B STEM	MJ Mars-1
HEAD SET	FSA IS-3E Integrated
HUB-FRONT	DH Pro 32hole
HUB-FRONT AXLE	20mm
HUB-REAR	Jump Pro 32hole
HUB-REAR AXLE	10mm axle
WHEELSIZE	26"
PEDAL	Wellgo B108
RIM	Alex Supra30
SADDLE	Velo VL-7081 Pivotal
SEAT CLAMP	integriert
SEAT POST	Premetec Pivotal
SHIFTER-FRONT	
SHIFTER-REAR	
SPOKE	PSR14
TIRE-FRONT	Maxxis DTH 26x2.15 FW120 70aMP
TIRE-REAR	Maxxis DTH 26x2.15 FW120 70aMP
OTHER	

## GEOMETRY

FRAME SIZE		13"
FRAME LENGTH IN MM	CT	330
FRAME SIZE IN MM	AH	580
TOP TUBE HORIZON IN MM	A	570
SEAT TUBE IN MM	C	298
DROP OUT INNER WIDTH		135
CHAIN STAYS IN MM	D	400
HEAD TUBE ANGLE	Q1	70,25
SEAT TUBE ANGLE	Q7	68,5
SEAT TUBE DIAMETER IN MM		27,2
BOTTOM BRACKET DROP IN MM	H	24
BOTTOM BRACKET WIDTH IN MM		73
WHEEL BASE IN MM	W	1335
FORK OFFSET IN MM	F	40
HEAD TUBE LENGTH IN MM	L	110
STEERER DIAMETER IN INCH		1 1/8"
FORK LENGTH IN MM	G	463
ISCG		no

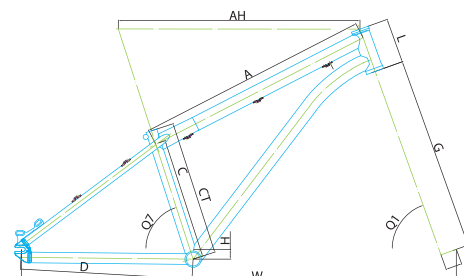

## NEWS BLOG

Revised frame with new BB and dropout  
 Serial frame weight of 2.58 kg  
 Samox BMX crank (2-parts)  
 New stem-handlebar combination  
 Pivotal saddle





# HARDY STEEL 1



## SPECIFICATIONS

FRAME	2012 Hardy Steel pro
SIZE	13"
WEIGHT	13,5 kg
FRAMEWEIGHT	2,58 kg
COLORCODE	black-colored (M45U)
TUBE	seamless DB tube
PRODUCTION	welded
MATERIAL	Full Cr-Mo
GO	Single speed
DROP-OUT	
SHOCK	
TRAVEL FRONT	
FORK	Marzocchi DJ Comp
TRAVEL FRONT	100mm
BB SET	Samox EBA-48 Euro Type
BRAKE-LEVER	TektroAuriga Comp, 160mm
BRAKE-FRONT	Tektro Auriga Comp, 160mm
BRAKE-REAR	Tektro Auriga Comp, 160mm
CHAIN	KMC Z610HX
CHAINGUARD	
CHAINWHEEL	Samox BFC-1818 & CW-1416M 25T
DERA-FRONT	
DERA-REAR	
FREEWHEEL	10T
GRIP	Velo VLG-808AD2-2L
H-BAR	MJ-203CR R:38 CrMo
H-B STEM	MJ RAYGUN L:52mm
HEAD SET	FSA IS-3E Integrated
HUB-FRONT	Disc Alloy
HUB-FRONT AXLE	5 mm Quickrelase
HUB-REAR	Jump disc 32hole
HUB-REAR AXLE	10mm axle
WHEELSIZE	26"
PEDAL	Wellbo B107
RIM	Alex DM24
SADDLE	Velo VL-7081 Pivotal
SEAT CLAMP	integrated
SEAT POST	Premetec Pivotal
SHIFTER-FRONT	
SHIFTER-REAR	
SPOKE	Satinless 2.0
TIRE-FRONT	CST C-1381 2.4 27 TPI
TIRE-REAR	CST C-1381 2.4 27 TPI
OTHER	

## GEOMETRY

FRAME SIZE		13"
FRAME LENGTH IN MM	CT	330
FRAME SIZE IN MM	AH	580
TOP TUBE HORIZON IN MM		570
SEAT TUBE IN MM	C	298
DROP OUT INNER WIDTH		135
CHAIN STAYS IN MM	D	400
HEAD TUBE ANGLE	Q1	70,25
SEAT TUBE ANGLE	Q7	68,5
SEAT TUBE DIAMETER IN MM		27,2
BOTTOM BRACKET DROP IN MM	H	24
BOTTOM BRACKET WIDTH IN MM		73
WHEEL BASE IN MM	W	1335
FORK OFFSET IN MM	F	40
HEAD TUBE LENGTH IN MM	L	110
STEERER DIAMETER IN INCH		1 1/8"
FORK LENGTH IN MM	G	463
ISCG		no

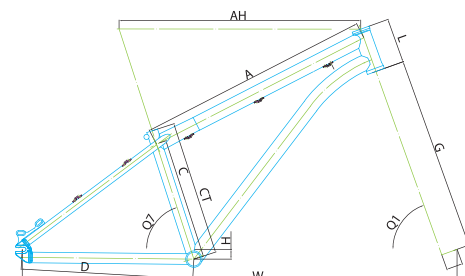

## NEWS BLOG

Revised frame with new BB and dropout  
 Serial frame weight of 2.58 kg  
 Samox BMX crank (2-parts)  
 New stem-handlebar combination  
 Pivotal saddle

# HARDY STEEL 2 26" + 24"



Street  
Urban



## SPECIFICATIONS

FRAME	2013 Hardy Steel comp
SIZE	13"
WEIGHT	14,3 kg
FRAMEWEIGHT	2,9 kg
COLORCODE	black-colored (G1M)
TUBE	seamless DB tube
PRODUCTION	welded
MATERIAL	Cr-Mo
GO	Single speed
DROP-OUT	
SHOCK	
TRAVEL FRONT	
FORK	RST Dirt T
TRAVEL FRONT	100mm
BB SET	Samox AX02-EBS-4
BRAKE-LEVER	UMF
BRAKE-FRONT	Hayes MX-4 Disc 160
BRAKE-REAR	Hayes MX-4 Disc 160
CHAIN	KMC Z610HX
CHAINGUARD	
CHAINWHEEL	Samox BFC-21S+CW-1329M 25T
DERA-FRONT	
DERA-REAR	
FREEWHEEL	10T
GRIP	Velo VLG-411-1A
H-BAR	MJ-203CR R3:8 CrMo
H-B STEM	MJ UMF-998M
HEAD SET	FSA IS-3E Integrated
HUB-FRONT	Disc Alloy
HUB-FRONT AXLE	5 mm Quickrelase
HUB-REAR	Jump disc 32hole
HUB-REAR AXLE	10mm axle
WHEELSIZE	26" and 24"
PEDAL	BMX Screw pin 9/16
RIM	Alex DM24
SADDLE	Velo VL-7083
SEAT CLAMP	integrated
SEAT POST	UMF Dirt CR15
SHIFTER-FRONT	
SHIFTER-REAR	
SPOKE	Satinless 2.0
TIRE-FRONT	CST C-1381 2.4 27 TPI
TIRE-REAR	CST C-1381 2.4 27 TPI
OTHER	

## GEOMETRY

FRAME SIZE		13"
FRAME LENGTH IN MM	CT	330
FRAME SIZE IN MM	AH	580
TOP TUBE HORIZON IN MM		570
SEAT TUBE IN MM	C	298
DROP OUT INNER WIDTH		135
CHAIN STAYS IN MM	D	400
HEAD TUBE ANGLE	Q1	70,25
SEAT TUBE ANGLE	Q7	68,5
SEAT TUBE DIAMETER IN MM		27,2
BOTTOM BRACKET DROP IN MM	H	24
BOTTOM BRACKET WIDTH IN MM		73
WHEEL BASE IN MM	W	1335
FORK OFFSET IN MM	F	40
HEAD TUBE LENGTH IN MM	L	110
STEERER DIAMETER IN INCH		1 1/8"
FORK LENGTH IN MM	G	463
ISCG		no

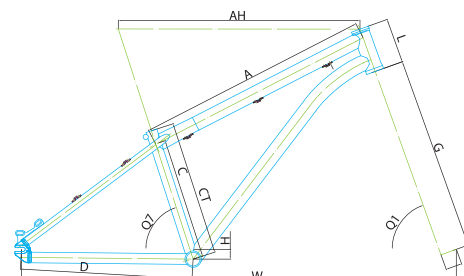

## NEWS BLOG

**Mech. discbrake**  
**3-piece Samox BMX chainwheel**  
**New h-stem and handlebar**



# HARDY 4X TEAM



4X  
BMX Race



## SPECIFIKATIONS

FRAME	2011 Hardy Pro Disc
SIZE	S/M/L
WEIGHT	12,6 kg
FRAMEWEIGHT	2,19 kg
COLORCODE	teamgreen (G21Y)
TUBE	Low Profile HFS
PRODUCTION	TIG welding
MATERIAL	Alloy 6061
60	10
DROP-OUT	
SHOCK	
TRAVEL FRONT	
FORK	Marzocchi 4X
TRAVEL FRONT	100 mm
BB SET	Truvativ Howitzer
BRAKE-LEVER	Hayes Stroker Trail
BRAKE-FRONT	Hayes Stroker Trail, 160mm
BRAKE-REAR	Hayes Stroker Trail, 180mm
CHAIN	SRAM PC-1051
CHAINGUARD	MRP Mini-G
CHAINWHEEL	Truvativ Holzfeller 1.1BG 36T
DERA-FRONT	
DERA-REAR	SRAM X.9 10s short cage
FREEWHEEL	SRAM PG-1070 11-28
GRIP	Velo VLG-884AD2-2L
H-BAR	Truvativ Holzfeller WC R:20
H-B STEM	MJ TB-203 L:50 0"
HEAD SET	FSA BB410
HUB-FRONT	DH Pro 32 hole
HUB-FRONT AXLE	20 mm
HUB-REAR	DH Pro 32 hole
HUB-REAR AXLE	10 mm Quickrelease
WHEELSIZE	26"
PEDAL	
RIM	Alex SUPRA 30
SADDLE	Velo VL-4157
SEAT CLAMP	UMF QR
SEAT POST	Aricle YC-SP-A533
SHIFTER-FRONT	
SHIFTER-REAR	SRAM X.7 SL Trigger
SPOKE	PSR14
TIRE-FRONT	Maxxis Larsen TT 2.35 60 KV
TIRE-REAR	Maxxis Larsen TT 2.35 60 KV
OTHER	

## GEOMETRY

FRAME SIZE		S (22")	M (23")	L (24")
FRAME LENGTH IN MM	CT	335	350	350
FRAME SIZE IN MM	AH	550	580	610
TOP TUBE HORIZON IN MM	A	541	562	589
SEAT TUBE IN MM	C	260	280	280
DROP OUT INNER WIDTH		135	135	135
CHAIN STAYS IN MM	D	407	408	408
HEAD TUBE ANGLE	Q1	69,5	69,5	69,5
SEAT TUBE ANGLE	Q7	72	72	72
SEAT TUBE DIAMETER IN MM		31,6	31,6	31,6
BOTTOM BRACKET DROP IN MM	H	28	28	28
BOTTOM BRACKET WIDTH IN MM		73	73	73
WHEEL BASE IN MM	W	1018	1048	1078
FORK OFFSET IN MM	F	38	38	38
HEAD TUBE LENGTH IN MM	L	115	115	115
STEERER DIAMETER IN INCH		1 1/8"	1 1/8"	1 1/8"
FORK LENGTH IN MM	G	466	466	466
ISCG		ISCG 03+05	ISCG 03+05	ISCG 03+05

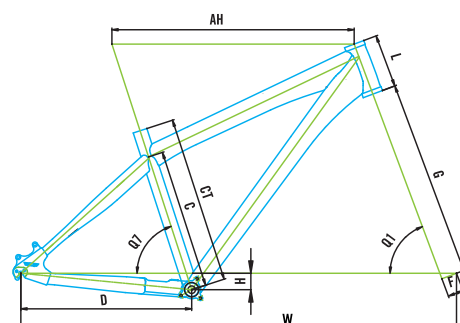

## NEWS BLOG

New frame geometry in 3 different length  
Steerer: 1-1/8",  
„Low Profile HFS Top Tube“  
ISCG 03+05



Low Profile HFS Top Tube Top Tube:  
Verringert die Verletzungsgefahr durch überstehende  
Zuganschläge und erhöht die Stabilität des Rahmens

# HARDY 4X



4X  
BMX Race



## SPECIFIKATIONS

FRAME	2011 Hardy Pro Disc
SIZE	S/M/L
WEIGHT	13,4 kg
FRAMEWEIGHT	2,19 kg
COLORCODE	darksilver (K11J)
TUBE	Low Profile HFS
PRODUCTION	TIG welding
MATERIAL	Alloy 6061
GO	9
DROP-OUT	
SHOCK	
TRAVEL FRONT	
FORK	Marzocchi Dirt Jumper 3
TRAVEL FRONT	100 mm
BB SET	Truvativ Howitzer
BRAKE-LEVER	Tektro Auriga Pro
BRAKE-FRONT	Tektro Auriga Pro, 160mm
BRAKE-REAR	Tektro Auriga Pro, 180mm
CHAIN	KMC X9
CHAINGUARD	MRP Mini-G steel
CHAINWHEEL	Truvativ Hussefelt 1.0BG 36T
DERA-FRONT	
DERA-REAR	SRAM X.7 9s short cage
FREEWHEEL	SRAM PG-950 11-28
GRIP	Velo VLG-884AD2-2L
H-BAR	Truvativ Hussefelt R:20
H-B STEM	Truvativ Hussefelt L:40
HEAD SET	FSA BB410
HUB-FRONT	DH Pro 32 hole
HUB-FRONT AXLE	20 mm
HUB-REAR	DH Pro 32 hole
HUB-REAR AXLE	10 mm Quickrelase
WHEELSIZE	26"
PEDAL	
RIM	Alex SUPRA BH
SADDLE	Velo VL-4157
SEAT CLAMP	UMF QR
SEAT POST	Aricle YC-SP-A533
SHIFTER-FRONT	
SHIFTER-REAR	SRAM X.7 SL Trigger
SPOKE	PSR14
TIRE-FRONT	Maxxis Larsen TT 2.35 60 KV
TIRE-REAR	Maxxis Larsen TT 2.35 60 KV
OTHER	

## GEOMETRY

FRAME SIZE		S (22")	M (23")	L (24")
FRAME LENGTH IN MM	CT	335	350	350
FRAME SIZE IN MM	AH	550	580	610
TOP TUBE HORIZON IN MM	A	541	562	589
SEAT TUBE IN MM	C	260	280	280
DROP OUT INNER WIDTH		135	135	135
CHAIN STAYS IN MM	D	407	408	408
HEAD TUBE ANGLE	Q1	69,5	69,5	69,5
SEAT TUBE ANGLE	Q7	72	72	72
SEAT TUBE DIAMETER IN MM		31,6	31,6	31,6
BOTTOM BRACKET DROP IN MM	H	28	28	28
BOTTOM BRACKET WIDTH IN MM		73	73	73
WHEEL BASE IN MM	W	1018	1048	1078
FORK OFFSET IN MM	F	38	38	38
HEAD TUBE LENGTH IN MM	L	115	115	115
STEERER DIAMETER IN INCH		1 1/8"	1 1/8"	1 1/8"
FORK LENGTH IN MM	G	466	466	466
ISCG		ISCG 03+05	ISCG 03+05	ISCG 03+05

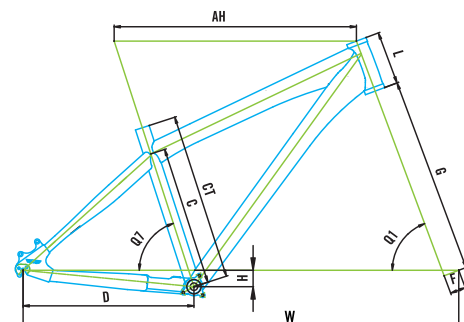

## NEWS BLOG

New frame geometry in 3 different length  
Steerer: 1-1/8",  
„Low Profile HFS Top Tube“  
ISCG 03+05



Low Profile HFS Top Tube Top Tube:  
Verringert die Verletzungsgefahr durch überstehende  
Zuganschläge und erhöht die Stabilität des Rahmens





## IMPORTANT WARNING FOR HARDY 4 DISC, HARDY 5 DISC AND HARDY 6



### WARNING

Do not use for  
Dirt Jump,  
Freeride and DH!  
Read owners-  
manual first!

Safety advice for the models Hardy 4 Disc, Hardy 5 Disc and Hardy 6:

Besides no-compromise dirtbikes, the UMF portfolio also offers juvenile models resembling the “big” originals to a great extent. But Dirtjump means extreme stress with respect to material. While some components of our juvenile bikes are suitable for this challenging discipline, others (primarily relevant ones!) are not.

Therefore: Bikes with the corresponding warning sticker on the top tube’s upper side **MUST NOT BE USED for Dirtjump!**

In most cases, full suitability can be achieved by subsequent upgrading respectively professional exchange of all relevant components. This option must be checked thoroughly and separately for each model.

Please point out these important facts explicitly during every sales advisory service concerning the models

Hardy 4 Disc  
Hardy 5 Disc  
Hardy 6

Additionally, please advise customers to follow all usage, maintenance and safety instructions in the UMF manual. Thus, it is always obligatory to hand out the manual together with the bike.

This straightforward manner also helps to preserve long-term customer loyalty for your business and UMF – because customer safety is generally most important to you and us!

# HARDY 4 DISC



## SPECIFICATIONS

FRAME	2010 Hardy Comp disc
SIZE	13"-14.5"- 16"- 18"
WEIGHT	14,5 kg
FRAMEWEIGHT	2,4 kg
COLORCODE	grey (TC-7602)
TUBE	PG tube Extraction
PRODUCTION	TIG welding
MATERIAL	Alloy 6061
GO	27
DROP-OUT	
SHOCK	
TRAVEL FRONT	
FORK	RST Dirt T
TRAVEL FRONT	100 mm
BB SET	Truvativ BB POWER SPLINE
BRAKE-LEVER	Tektro Draco
BRAKE-FRONT	Tektro Draco, 180mm
BRAKE-REAR	Tektro Draco, 180mm
CHAIN	Shimano CN-HG53
CHAINGUARD	
CHAINWHEEL	Truvativ ISOFLOW FC 44/32/22
DERA-FRONT	Shimano Alivio
DERA-REAR	Shimano Alivio
FREEWHEEL	Shimano HG30-9 11-32
GRIP	Velo VLG-539AD2
H-BAR	UMF OV RISE
H-B STEM	UMF OV L:50
HEAD SET	FSA No.10
HUB-FRONT	Disc Alloy 32 hole
HUB-FRONT AXLE	5 mm Quickrelase
HUB-REAR	Disc Alloy 32 hole
HUB-REAR AXLE	5 mm Quickrelase
WHEELSIZE	26"
PEDAL	BMX Screw pin
RIM	Alex DM18
SADDLE	Velo VL-7083
SEAT CLAMP	UMF QR
SEAT POST	MJ MSP-15AL.1 31.6D*350L
SHIFTER-FRONT	Shimano Alivio rapidfire
SHIFTER-REAR	Shimano Alivio rapidfire
SPOKE	Stainless 2.0
TIRE-FRONT	Maxxis Holly Roller 2.2 60
TIRE-REAR	Maxxis Holly Roller 2.2 60
OTHER	

## GEOMETRY

FRAME SIZE		SX	S	M	L
FRAME LENGTH IN MM	CT	340	368	407	458
FRAME SIZE IN MM	AH	520	553	590	638
TOP TUBE HORIZON IN MM	A	514	540	568	608
SEAT TUBE IN MM	C	282	298	324	376
DROP OUT INNER WIDTH		135	135	135	135
CHAIN STAYS IN MM	D	418	418	418	418
HEAD TUBE ANGLE	Q1	69,5	69,5	69,5	69,5
SEAT TUBE ANGLE	Q7	72	72	72	72
SEAT TUBE DIAMETER IN MM		31,6	31,6	31,6	31,6
BOTTOM BRACKET DROP IN MM	H	40	40	40	40
BOTTOM BRACKET WIDTH IN MM		73	73	73	73
WHEEL BASE IN MM	W	991	1024	1064	1109
FORK OFFSET IN MM	F	38	38	38	38
HEAD TUBE LENGTH IN MM	L	115	115	115	115
STEERER DIAMETER IN INCH		1 1/8"	1 1/8"	1 1/8"	1 1/8"
FORK LENGTH IN MM	G	466	466	466	466
ISCG		no	no	no	no

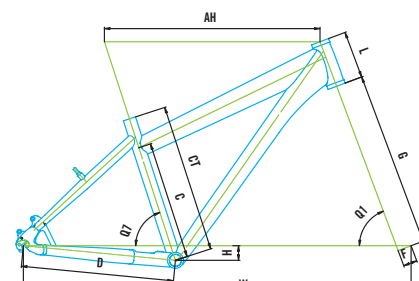

## NEWS BLOG

**New hydraulic Disc Brake: Tektro Draco**  
**New small framesize: XS (13")**



# HARDY 5 DISC



## SPECIFICATIONS

FRAME	2010 Hardy Comp disc
SIZE	13"-14.5"- 16"- 18"
WEIGHT	14,9 kg
FRAMEWEIGHT	2,4 kg
COLORCODE	white (P13Z)
TUBE	PG tube Extraction
PRODUCTION	TIG welding
MATERIAL	Alloy 6061
60	24
DROP-OUT	
SHOCK	
TRAVEL FRONT	
FORK	RST Dirt T
TRAVEL FRONT	100 mm
BB SET	Truvativ BB POWER SPLINE
BRAKE-LEVER	Hayes
BRAKE-FRONT	Hayes MX-4 Disc 160
BRAKE-REAR	Hayes MX-4 Disc 160
CHAIN	Shimano CN-HG50
CHAINGUARD	
CHAINWHEEL	Truvativ ISOFLOW FC 44/32/23
DERA-FRONT	Shimano M310 T-Swing
DERA-REAR	Shimano Acera-X
FREEWHEEL	Shimano CS-HG40-8I
GRIP	Velo VLG-539AD2
H-BAR	UMF OV RISE
H-B STEM	UMF OV L:50
HEAD SET	FSA No.10
HUB-FRONT	Disc Alloy 32 hole
HUB-FRONT AXLE	5 mm Quickrelase
HUB-REAR	Disc Alloy 32 hole
HUB-REAR AXLE	5 mm Quickrelase
WHEELSIZE	26"
PEDAL	BMX Pedal
RIM	Alex DM18
SADDLE	Velo VL-7083
SEAT CLAMP	UMF QR
SEAT POST	MJ MSP-15AL.1 31.6D
SHIFTER-FRONT	Shimano ACERA-X
SHIFTER-REAR	Shimano ACERA-X
SPOKE	Stainless 2.0
TIRE-FRONT	Maxxis Holly Roller 2.2 60
TIRE-REAR	Maxxis Holly Roller 2.2 60
OTHER	

## GEOMETRY

FRAME SIZE		SX	S	M	L
FRAME LENGTH IN MM	CT	340	368	407	458
FRAME SIZE IN MM	AH	520	553	590	638
TOP TUBE HORIZON IN MM	A	514	540	568	608
SEAT TUBE IN MM	C	282	298	324	376
DROP OUT INNER WIDTH		135	135	135	135
CHAIN STAYS IN MM	D	418	418	418	418
HEAD TUBE ANGLE	Q1	69,5	69,5	69,5	69,5
SEAT TUBE ANGLE	Q7	72	72	72	72
SEAT TUBE DIAMETER IN MM		31,6	31,6	31,6	31,6
BOTTOM BRACKET DROP IN MM	H	40	40	40	40
BOTTOM BRACKET WIDTH IN MM		73	73	73	73
WHEEL BASE IN MM	W	991	1024	1064	1109
FORK OFFSET IN MM	F	38	38	38	38
HEAD TUBE LENGTH IN MM	L	115	115	115	115
STEERER DIAMETER IN INCH		1 1/8"	1 1/8"	1 1/8"	1 1/8"
FORK LENGTH IN MM	G	466	466	466	466
ISCG		no	no	no	no

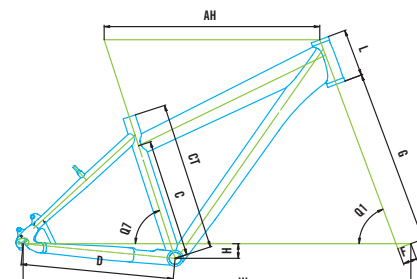

## NEWS BLOG

New small framesize: XS (13")

# HARDY 6



## SPECIFIKATIONS

FRAME	2010 Hardy Comp disc
SIZE	13"-14.5"- 16"- 18"
WEIGHT	14,8 kg
FRAMEWEIGHT	2,4 kg
COLORCODE	Sand (M38T)
TUBE	PG tube Extraction
PRODUCTION	TIG welding
MATERIAL	Alloy 6061
GO	21
DROP-OUT	
SHOCK	
TRAVEL FRONT	
FORK	RST Dirt T
TRAVEL FRONT	100 mm
BB SET	Truvativ BB POWER SPLINE
BRAKE-LEVER	attached
BRAKE-FRONT	V-Brake
BRAKE-REAR	V-Brake
CHAIN	Shimano UG51
CHAINGUARD	
CHAINWHEEL	Truvativ ISOFLOW FC 44/32/24
DERA-FRONT	Shimano TY10
DERA-REAR	Shimano Altus
FREEWHEEL	Shimano MF-TZ21 14-28
GRIP	Merida DB
H-BAR	UMF OV RISE
H-B STEM	TDS-A141-8FOV
HEAD SET	FSA No.10
HUB-FRONT	OV black
HUB-FRONT AXLE	5 mm Quickrelase
HUB-REAR	Alloy 32 hole
HUB-REAR AXLE	5 mm Quickrelase
WHEELSIZE	26"
PEDAL	BMX Pedal
RIM	Alex DM18
SADDLE	FM2462
SEAT CLAMP	UMF QR
SEAT POST	MJ MSP-15AL.1 31.6D
SHIFTER-FRONT	Shimano Altus C90
SHIFTER-REAR	Shimano Altus C90
SPOKE	Stainless 2.0
TIRE-FRONT	CST C-1648 2.25 27 TPI
TIRE-REAR	CST C-1648 2.25 27 TPI
OTHER	

## GEOMETRY

FRAME SIZE		SX	S	M	L
FRAME LENGTH IN MM	CT	340	368	407	458
FRAME SIZE IN MM	AH	520	553	590	638
TOP TUBE HORIZON IN MM	A	514	540	568	608
SEAT TUBE IN MM	C	282	298	324	376
DROP OUT INNER WIDTH		135	135	135	135
CHAIN STAYS IN MM	D	418	418	418	418
HEAD TUBE ANGLE	Q1	69,5	69,5	69,5	69,5
SEAT TUBE ANGLE	Q7	72	72	72	72
SEAT TUBE DIAMETER IN MM		31,6	31,6	31,6	31,6
BOTTOM BRACKET DROP IN MM	H	40	40	40	40
BOTTOM BRACKET WIDTH IN MM		73	73	73	73
WHEEL BASE IN MM	W	991	1024	1064	1109
FORK OFFSET IN MM	F	38	38	38	38
HEAD TUBE LENGTH IN MM	L	115	115	115	115
STEERER DIAMETER IN INCH		1 1/8"	1 1/8"	1 1/8"	1 1/8"
FORK LENGTH IN MM	G	466	466	466	466
ISCG		no	no	no	no

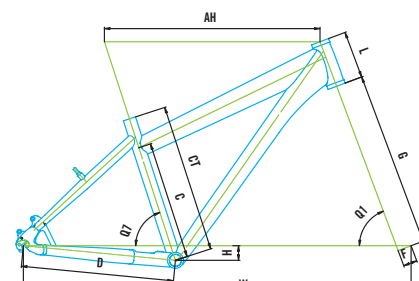

## NEWS BLOG

New small framesize: XS (13")



BRAD DJ SERIES



New CWI 1197 fork (840 g) with optimized tube stiffness, CNC-machined head tube, heat-treated CrMo 4130



2-parts crank for improved stability at less weight! 745g, 19mm axle and 48T spindle. Check out the Bard DJ Team

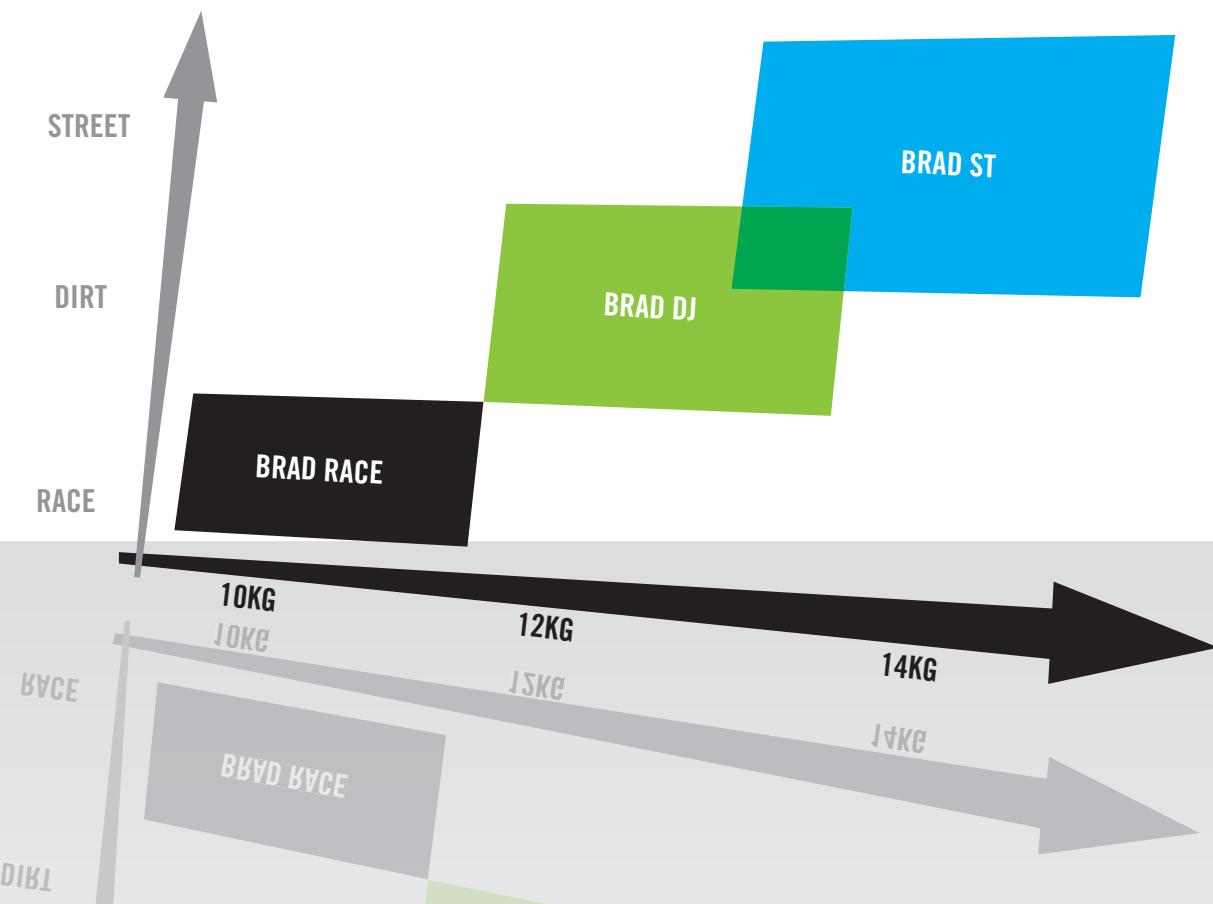

# BRAD DJ TEAM



## SPECIFIKATIONS

FRAME	2010 Brad DJ Team
SIZE	
WEIGHT	9,95 kg
FRAMEWEIGHT	2,27 kg
COLORCODE	black-colored (M38E)
TUBE	Seamless tube
PRODUCTION	welding
MATERIAL	Full CrMo
GO	Single speed
DROP-OUT	
SHOCK	
TRAVEL FRONT	
FORK	CWI-1197 3/8" Cr-Mo
TRAVEL FRONT	
BB SET	Samox MB-48 MID BB
BRAKE-LEVER	Right:TRP XL 950
BRAKE-FRONT	U-Brake
BRAKE-REAR	Tektro TRP FX 950
CHAIN	KMC K710SL
CHAINGUARD	
CHAINWHEEL	Samox BFC-1818 & MJ-ST04 22T
DERA-FRONT	
DERA-REAR	
FREEWHEEL	8T
GRIP	Velo VLG-411-1A
H-BAR	MJ-213 R:196 W:710
H-B STEM	MJ Mars-1
HEAD SET	FSA No.8D
HUB-FRONT	BMX Bearing 32 hole
HUB-FRONT AXLE	3/8" axle
HUB-REAR	BMX Pro Bearing 36 hole
HUB-REAR AXLE	14mm axle
WHEELSIZE	20"
PEDAL	Wellgo B030
RIM	Alex SupraDOME
SADDLE	Velo VL-7081 Pivotal
SEAT CLAMP	UMF
SEAT POST	Premetec Pivotal 25.4*135L
SHIFTER-FRONT	
SHIFTER-REAR	
SPOKE	Stainless 2.0
TIRE-FRONT	Maxxis DHT 2.2 60TPI
TIRE-REAR	Maxxis DHT 1.95 60TPI
OTHER	

## GEOMETRY

FRAME SIZE		22,125
FRAME LENGTH IN MM	CT	240
FRAME SIZE IN MM	AH	562
TOP TUBE HORIZON IN MM	A	531
SEAT TUBE IN MM	C	200
DROP OUT INNER WIDTH		110
CHAIN STAYS IN MM	D	335
HEAD TUBE ANGLE	Q1	74,5
SEAT TUBE ANGLE	Q7	71
SEAT TUBE DIAMETER IN MM		25,4
BOTTOM BRACKET DROP IN MM	H	35
BOTTOM BRACKET WIDTH IN MM		68
WHEEL BASE IN MM	W	920
FORK OFFSET IN MM	F	35
HEAD TUBE LENGTH IN MM	L	100
STEERER DIAMETER IN INCH		1 1/8"
FORK LENGTH IN MM	G	315
ISCG		nein

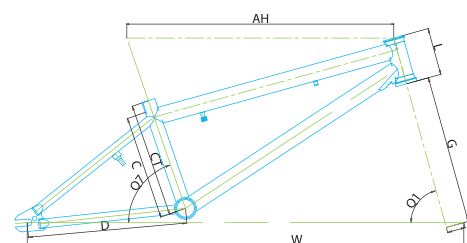

## NEWS BLOG

- New CWI 1197 fork (840 g) with optimized tube stiffness, CNC-machined head tube, heat-treated CrMo 4130 – 700 g lighter than in MY 2010!
- New MJ Cyles handlebars, 13-buttet and heat-treated
- New stem with inside head tube clamping (257 g), CNC-machined from AL 6061/T6
- 2-piece crank for improved stability at less weight!
- 48 teeth for super-solid connection between crank and axle
- 22T/8T Ultramirco Transition for optimal 2.75 transmission ratio
- Pivotal saddle/seat post



# BRAD DJ 1



## SPECIFIKATIONS

FRAME	2010 Brad DJ Team
SIZE	
WEIGHT	10,3 kg
FRAMEWEIGHT	2,27 kg
COLORCODE	black-colored (M45U)
TUBE	Seamless tube
PRODUCTION	welding
MATERIAL	Full CrMo
GO	Single speed
DROP-OUT	
SHOCK	
TRAVEL FRONT	
FORK	CWI-1197 3/8" Cr-Mo
TRAVEL FRONT	
BB SET	Samox MB-48 MID BB
BRAKE-LEVER	Rechts Tektro 289A
BRAKE-FRONT	U-Brake
BRAKE-REAR	Tektro FX15 U-brake
CHAIN	KMC K710
CHAINGUARD	
CHAINWHEEL	Samox BFC-1818 & CW-1416M 25T
DERA-FRONT	
DERA-REAR	
FREEWHEEL	9T
GRIP	Velo VLG-411-1A
H-BAR	MJ-211 R:196 W:710
H-B STEM	MJ MF-960
HEAD SET	FSA No.8D
HUB-FRONT	BMX Bearing 32 hole
HUB-FRONT AXLE	3/8" axle
HUB-REAR	BMX Comp Bearing 36 hole
HUB-REAR AXLE	14mm axle
WHEELSIZE	20"
PEDAL	BMX 9/16"
RIM	Alex DM24
SADDLE	Velo VL-7081 Pivotal
SEAT CLAMP	UMF
SEAT POST	Premetec Pivotal 25.4*135L
SHIFTER-FRONT	
SHIFTER-REAR	
SPOKE	UCP 2.0
TIRE-FRONT	Maxxis Holy Roller 2.2 60TPI
TIRE-REAR	Maxxis Holy Roller 1.95 60TPI
OTHER	

## GEOMETRY

FRAME SIZE		22,125
FRAME LENGTH IN MM	CT	240
FRAME SIZE IN MM	AH	562
TOP TUBE HORIZON IN MM	A	531
SEAT TUBE IN MM	C	200
DROP OUT INNER WIDTH		110
CHAIN STAYS IN MM	D	335
HEAD TUBE ANGLE	Q1	74,5
SEAT TUBE ANGLE	Q7	71
SEAT TUBE DIAMETER IN MM		25,4
BOTTOM BRACKET DROP IN MM	H	35
BOTTOM BRACKET WIDTH IN MM		68
WHEEL BASE IN MM	W	920
FORK OFFSET IN MM	F	35
HEAD TUBE LENGTH IN MM	L	100
STEERER DIAMETER IN INCH		1 1/8"
FORK LENGTH IN MM	G	315
ISCG		nein

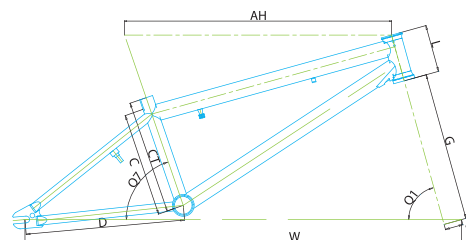

## NEWS BLOG

- New CWI 1197 fork (840 g) with optimized tube stiffness, CNC-machined head tube, heat-treated CrMo 4130 – 700 g lighter than in MY 2010!
- New MJ Cyles handlebars, 11-buttend and heat-treated
- New stem
- 3-piece crank for improved stability at less weight!
- 48 teeth for super-solid connection between crank and axle
- Pivotal saddle/seat post

# BRAD DJ 2



Dirt



## SPECIFIKATIONS

FRAME	2010 Brad DJ Team
SIZE	
WEIGHT	10,5 kg
FRAMEWEIGHT	2,27 kg
COLORCODE	black-colored (G1M)
TUBE	Seamless tube
PRODUCTION	welding
MATERIAL	Full CrMo
GO	Single speed
DROP-OUT	
SHOCK	
TRAVEL FRONT	
FORK	CWI-1197 3/8" Cr-Mo
TRAVEL FRONT	
BB SET	Samox MID BB
BRAKE-LEVER	Rechts Tektro 273A
BRAKE-FRONT	U-Brake
BRAKE-REAR	Tektro FX11 U-brake
CHAIN	KMC Z510H
CHAINGUARD	
CHAINWHEEL	Samox 3-unit Chainwheel 25T
DERA-FRONT	
DERA-REAR	
FREEWHEEL	9T
GRIP	Velo VLG-411-1A
H-BAR	UMF CrMo W:635 R:190
H-B STEM	MJ UMF-998M
HEAD SET	FSA No.8D
HUB-FRONT	BMX Bearing 32 hole
HUB-FRONT AXLE	3/8" axle
HUB-REAR	BMX Bearing 36 hole
HUB-REAR AXLE	14mm axle
WHEELSIZE	20"
PEDAL	BMX 9/16"
RIM	Alex DDW
SADDLE	Velo VL-7081 Pivotal
SEAT CLAMP	UMF
SEAT POST	Premetec Pivotal 25.4*135L
SHIFTER-FRONT	
SHIFTER-REAR	
SPOKE	UCP 2.0
TIRE-FRONT	CST C-1381 2.2
TIRE-REAR	CST C-1381 1.95
OTHER	

## GEOMETRY

FRAME SIZE		22,125
FRAME LENGTH IN MM	CT	240
FRAME SIZE IN MM	AH	562
TOP TUBE HORIZON IN MM	A	531
SEAT TUBE IN MM	C	200
DROP OUT INNER WIDTH		110
CHAIN STAYS IN MM	D	335
HEAD TUBE ANGLE	Q1	74,5
SEAT TUBE ANGLE	Q7	71
SEAT TUBE DIAMETER IN MM		25,4
BOTTOM BRACKET DROP IN MM	H	35
BOTTOM BRACKET WIDTH IN MM		68
WHEEL BASE IN MM	W	920
FORK OFFSET IN MM	F	35
HEAD TUBE LENGTH IN MM	L	100
STEERER DIAMETER IN INCH		1 1/8"
FORK LENGTH IN MM	G	315
ISCG		nein

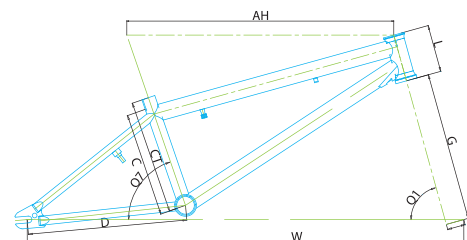

## NEWS BLOG

- New CWI 1197 fork (840 g) with optimized tube stiffness, CNC-machined head tube, heat-treated CrMo 4130 – 700 g lighter than in MY 2010!
- 3-piece crank for improved stability at less weight!
- Pivotal saddle/seat post

BRAD ST SERIES



New CWI 1197 fork (840 g) with optimized tube stiffness, CNC-machined head tube, heat-treated CrMo 4130



2-parts crank for improved stability at less weight! 745g, 19mm axle and 48T spindle. Check out the Bard ST 1

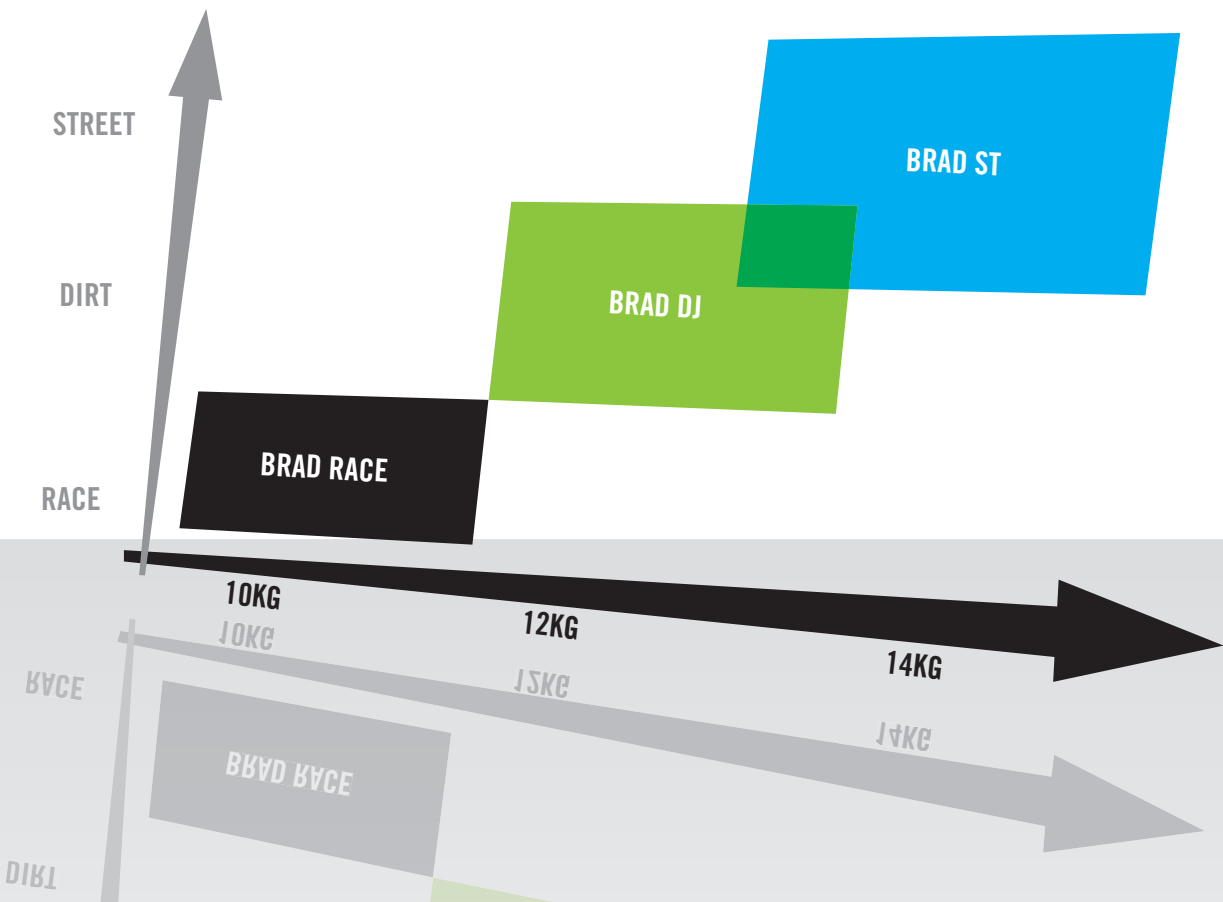



# BRAD ST 1



Street  
Urban



## SPECIFICATIONS

FRAME	2010 Brad DJ Team
SIZE	
WEIGHT	10,8 kg (+0,360 Pegs)
FRAMEWEIGHT	2,27 kg
COLORCODE	braun (P14L)
TUBE	Seamless tube
PRODUCTION	welding
MATERIAL	Full CrMo
GO	Single speed
DROP-OUT	
SHOCK	
TRAVEL FRONT	
FORK	CWI-1192 Cr-Mo
TRAVEL FRONT	
BB SET	Samox MB-48 MID BB
BRAKE-LEVER	Tektro 289A
BRAKE-FRONT	Tektro FX340F U-brake
BRAKE-REAR	Tektro FX341 U-brake
CHAIN	KMC K710
CHAINGUARD	
CHAINWHEEL	Samox BFC-1818 & CW-1416M 25T
DERA-FRONT	
DERA-REAR	
FREEWHEEL	9T
GRIP	Velo VLG-411-1A
H-BAR	MJ-211 R:196 W:710
H-B STEM	MJ Raygun L:52mm
HEAD SET	FSA No.8D + ORYG 48
HUB-FRONT	BMX Bearing 36 hole
HUB-FRONT AXLE	14mm axle
HUB-REAR	BMX Pro Bearing 48 hole
HUB-REAR AXLE	14mm axle
WHEELSIZE	20"
PEDAL	Wellgo B107
RIM	Alex DM24
SADDLE	Velo VL-7081 Pivotal
SEAT CLAMP	UMF
SEAT POST	Premetec Pivotal 25.4*135L
SHIFTER-FRONT	
SHIFTER-REAR	
SPOKE	UCP 2.0
TIRE-FRONT	Maxxis M-Tread 2.0 60TPI
TIRE-REAR	Maxxis M-Tread 2.0 60TPI
OTHER	4 x PVC London Mod

## GEOMETRY

FRAME SIZE		22,125
FRAME LENGTH IN MM	CT	240
FRAME SIZE IN MM	AH	562
TOP TUBE HORIZON IN MM	A	531
SEAT TUBE IN MM	C	200
DROP OUT INNER WIDTH		110
CHAIN STAYS IN MM	D	335
HEAD TUBE ANGLE	Q1	74,5
SEAT TUBE ANGLE	Q7	71
SEAT TUBE DIAMETER IN MM		25,4
BOTTOM BRACKET DROP IN MM	H	35
BOTTOM BRACKET WIDTH IN MM		68
WHEEL BASE IN MM	W	920
FORK OFFSET IN MM	F	35
HEAD TUBE LENGTH IN MM	L	100
STEERER DIAMETER IN INCH		1 1/8"
FORK LENGTH IN MM	G	315
ISCG		nein

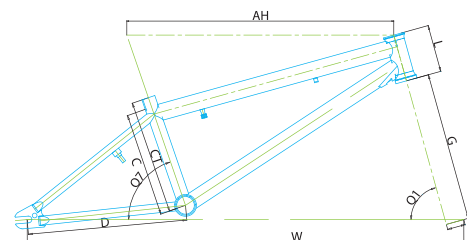

## NEWS BLOG

- New CWI 1197 fork (840 g) with optimized tube stiffness, CNC-machined head tube, heat-treated CrMo 4130 – 700 g lighter than in MY 2010!
- New MJ Cyles handlebars, 11-buttet and heat-treated
- New stem
- 2-piece crank for improved stability at less weight!
- 48 teeth for super-solid connection between crank and axle
- Pivotal saddle/seat post
- 4 x PVC Axlepegs

# BRAD ST 2



## SPECIFICATIONS

FRAME	2010 Brad DJ Team
SIZE	
WEIGHT	11,3 kg (+0,360 Pegs)
FRAMEWEIGHT	2,27 kg
COLORCODE	green (TC-9023)
TUBE	Seamless tube
PRODUCTION	welding
MATERIAL	Full CrMo
GO	Single speed
DROP-OUT	
SHOCK	
TRAVEL FRONT	
FORK	CWI-1192 Cr-Mo
TRAVEL FRONT	
BB SET	Samox MID BB
BRAKE-LEVER	Tektro 273A
BRAKE-FRONT	Tektro FX340 U-brake
BRAKE-REAR	Tektro FX340 U-brake
CHAIN	KMC Z510H
CHAINGUARD	
CHAINWHEEL	Samox 3-piece Chainwheel 25T
DERA-FRONT	
DERA-REAR	
FREEWHEEL	9T
GRIP	Velo VLG-411-1A
H-BAR	MJ-211 R:196 W:710
H-B STEM	MJ UMF-998M
HEAD SET	FSA No.8D + ORYG 48
HUB-FRONT	BMX Bearing 36 hole
HUB-FRONT AXLE	14mm axle
HUB-REAR	BMX Bearing 48 hole
HUB-REAR AXLE	14mm axle
WHEELSIZE	20"
PEDAL	Wellgo B107
RIM	Alex DDW
SADDLE	Velo VL-7081 Pivotal
SEAT CLAMP	UMF
SEAT POST	Premetec Pivotal 25.4*135L
SHIFTER-FRONT	
SHIFTER-REAR	
SPOKE	UCP 2.0
TIRE-FRONT	CST C-1381 1.95
TIRE-REAR	CST C-1381 1.95
OTHER	4 x PVC
	London Mod

## GEOMETRY

FRAME SIZE		22,125
FRAME LENGTH IN MM	CT	240
FRAME SIZE IN MM	AH	562
TOP TUBE HORIZON IN MM	A	531
SEAT TUBE IN MM	C	200
DROP OUT INNER WIDTH		110
CHAIN STAYS IN MM	D	335
HEAD TUBE ANGLE	Q1	74,5
SEAT TUBE ANGLE	Q7	71
SEAT TUBE DIAMETER IN MM		25,4
BOTTOM BRACKET DROP IN MM	H	35
BOTTOM BRACKET WIDTH IN MM		68
WHEEL BASE IN MM	W	920
FORK OFFSET IN MM	F	35
HEAD TUBE LENGTH IN MM	L	100
STEERER DIAMETER IN INCH		1 1/8"
FORK LENGTH IN MM	G	315
ISCG		nein

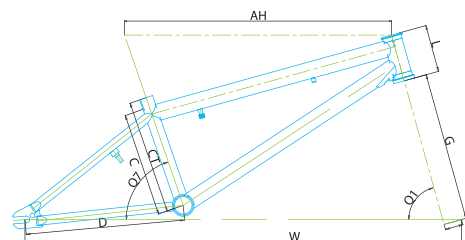

## NEWS BLOG

- New CWI 1197 fork (840 g) with optimized tube stiffness, CNC-machined head tube, heat-treated CrMo 4130 – 700 g lighter than in MY 2010!
- New MJ Cyles handlebars, 11-butt and heat-treated
- 3-piece crank for improved stability at less weight!
- 48 teeth for super-solid connection between crank and axle
- Pivotal saddle/seat post
- 4 x PVC Axlepegs

# BRAD ST 3



Street  
Urban



## SPECIFIKATIONS

FRAME	2009 Brad 1
SIZE	
WEIGHT	13,1 kg (+0,360 Pegs)
FRAMEWEIGHT	2,8 kg
COLORCODE	"1. red (TC-8426) 2. white (P132)"
TUBE	Seamless tube
PRODUCTION	welding
MATERIAL	Cr-Mo
60	Single speed
DROP-OUT	
SHOCK	
TRAVEL FRONT	
FORK	UMF CM 14
TRAVEL FRONT	
BB SET	Ball-Retainer
BRAKE-LEVER	Tektro 289A
BRAKE-FRONT	Tektro 907AFS U-brake
BRAKE-REAR	Tektro 907A U-brake
CHAIN	KMC Z410
CHAINGUARD	
CHAINWHEEL	Samox 3-piece Chainwheel 33T
DERA.-FRONT	
DERA.-REAR	
FREEWHEEL	13T
GRIP	Velo VLG-411-1A
H-BAR	UMF HT W-635 R:190
H-B STEM	MJ UMF-998M
HEAD SET	FSA TH888 + GRYG 48
HUB-FRONT	BMX Steel 36hole
HUB-FRONT AXLE	14mm axle
HUB-REAR	BMX Steel 14MM 48H
HUB-REAR AXLE	14mm axle
WHEELSIZE	20"
PEDAL	BMX Pedal
RIM	Alex DDW
SADDLE	Velo VL-7083
SEAT CLAMP	UMF
SEAT POST	UMF Dirt CR15 25,4
SHIFTER-FRONT	
SHIFTER-REAR	
SPOKE	UCP 2.0
TIRE-FRONT	CST C-1381 1.95
TIRE-REAR	CST C-1381 1.95
OTHER	4 x PVC London Mod

## GEOMETRY

FRAME SIZE		22,25
FRAME LENGTH IN MM	CT	240
FRAME SIZE IN MM	AH	565
TOP TUBE HORIZON IN MM	A	533
SEAT TUBE IN MM	C	194
DROP OUT INNER WIDTH		110
CHAIN STAYS IN MM	D	352
HEAD TUBE ANGLE	Q1	73,5
SEAT TUBE ANGLE	Q7	71
SEAT TUBE DIAMETER IN MM		25,4
BOTTOM BRACKET DROP IN MM	H	38
BOTTOM BRACKET WIDTH IN MM		68
WHEEL BASE IN MM	W	947,9
FORK OFFSET IN MM	F	38
HEAD TUBE LENGTH IN MM	L	100
STEERER DIAMETER IN INCH		1 1/8"
FORK LENGTH IN MM	G	325
ISCG		nein

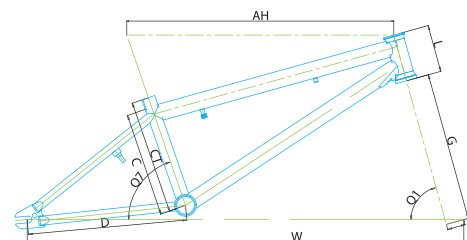

## NEWS BLOG

- 3-piece crank for improved stability at less weight!
- 4 x PVC Axlepegs



# BRAD ST 4



## SPECIFICATIONS

FRAME	2009 Brad 1
SIZE	
WEIGHT	13,6 kg (+0,360 Pegs)
FRAMEWEIGHT	2,8 kg
COLORCODE	white (P13Z)
TUBE	Seamless tube
PRODUCTION	welding
MATERIAL	Cr-Mo
GO	Single speed
DROP-OUT	
SHOCK	
TRAVEL FRONT	
FORK	UMF HT
TRAVEL FRONT	
BB SET	Ball-retainer
BRAKE-LEVER	Tektro 317A/L
BRAKE-FRONT	Tektro TK-918AF V-Brake
BRAKE-REAR	Tektro BX310R, Alloy V-Brake
CHAIN	KMC Z410
CHAINGUARD	
CHAINWHEEL	Samox 3-piece Chainwheel 33T
DERA-FRONT	
DERA-REAR	
FREEWHEEL	14T
GRIP	PVC
H-BAR	UMF HT W:635 R:146
H-B STEM	UMF
HEAD SET	FSA TH888 + GRYG 48
HUB-FRONT	BMX Steel 36hole
HUB-FRONT AXLE	14mm axle
HUB-REAR	BMX Steel 14MM 48H
HUB-REAR AXLE	14mm axle
WHEELSIZE	20"
PEDAL	BMX Pedal
RIM	Single Black
SADDLE	UMF
SEAT CLAMP	UMF
SEAT POST	UMF Dirt CR15 25.4
SHIFTER-FRONT	
SHIFTER-REAR	
SPOKE	UCP 2.0
TIRE-FRONT	CST C-1381 1.95
TIRE-REAR	CST C-1381 1.95
OTHER	4 x PVC
	London Mod

## GEOMETRY

FRAME SIZE		22,25
FRAME LENGTH IN MM	CT	240
FRAME SIZE IN MM	AH	565
TOP TUBE HORIZON IN MM		533
SEAT TUBE IN MM	C	194
DROP OUT INNER WIDTH		110
CHAIN STAYS IN MM	D	352
HEAD TUBE ANGLE	Q1	73,5
SEAT TUBE ANGLE	Q7	71
SEAT TUBE DIAMETER IN MM		25,4
BOTTOM BRACKET DROP IN MM	H	38
BOTTOM BRACKET WIDTH IN MM		68
WHEEL BASE IN MM	W	947,9
FORK OFFSET IN MM	F	38
HEAD TUBE LENGTH IN MM	L	100
STEERER DIAMETER IN INCH		1 1/8"
FORK LENGTH IN MM	G	325
ISCG		nein

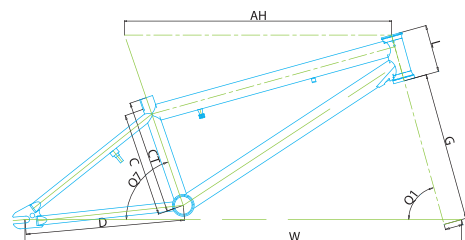

## NEWS BLOG

- 3-piece crank
- 4 x PVC Axlepegs

# BRAD ST 5



Street  
Urban



## SPECIFIKATIONS

FRAME	2009 Brad 1
SIZE	
WEIGHT	13,8 kg (+Steel Pegs)
FRAMEWEIGHT	2,8 kg
COLORCODE	dark blue (TC-8352)
TUBE	PG tube Extraction
PRODUCTION	welded
MATERIAL	Cr-Mo
GO	Single speed
DROP-OUT	
SHOCK	
TRAVEL FRONT	
FORK	UMF HT
TRAVEL FRONT	
BB SET	Ball-retainer
BRAKE-LEVER	Tektro 317A/L
BRAKE-FRONT	Tektro TK-918AF V-Brake
BRAKE-REAR	Tektro BX310R, Alloy V-Brake
CHAIN	KMC Z410
CHAINGUARD	
CHAINWHEEL	1-piece Chainwheel 33T
DERA-FRONT	
DERA-REAR	
FREEWHEEL	14T
GRIP	PVC
H-BAR	UMF HT W:635 R:146
H-B STEM	UMF
HEAD SET	FSA TH888 + GRYG 48
HUB-FRONT	BMX Steel 36hole
HUB-FRONT AXLE	14mm axle
HUB-REAR	BMX Steel 14MM 48H
HUB-REAR AXLE	14mm axle
WHEELSIZE	20"
PEDAL	BMX Pedal
RIM	Single Black
SADDLE	UMF
SEAT CLAMP	UMF
SEAT POST	STEEL 28.6
SHIFTER-FRONT	
SHIFTER-REAR	
SPOKE	UCP 2.0
TIRE-FRONT	CST C-1381 1.95
TIRE-REAR	CST C-1381 1.95
OTHER	4 x Steelpegs

## GEOMETRY

FRAME SIZE		22,25
FRAME LENGTH IN MM	CT	240
FRAME SIZE IN MM	AH	565
TOP TUBE HORIZON IN MM	A	533
SEAT TUBE IN MM	C	194
DROP OUT INNER WIDTH		110
CHAIN STAYS IN MM	D	352
HEAD TUBE ANGLE	Q1	73,5
SEAT TUBE ANGLE	Q7	71
SEAT TUBE DIAMETER IN MM		25,4
BOTTOM BRACKET DROP IN MM	H	38
BOTTOM BRACKET WIDTH IN MM		68
WHEEL BASE IN MM	W	947,9
FORK OFFSET IN MM	F	38
HEAD TUBE LENGTH IN MM	L	100
STEERER DIAMETER IN INCH		1 1/8"
FORK LENGTH IN MM	G	325
ISCG		nein

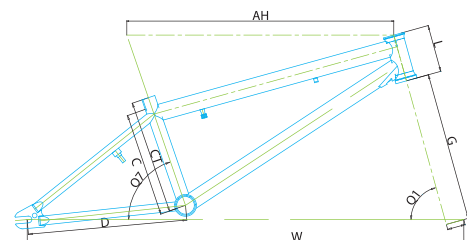

## NEWS BLOG

- 4 x Steel Axlepegs



BRAD RACE SERIES



New 2 piece Crankset at the ProXL, 970g and outside lying bearings

New CWI 1197 fork (840 g) with optimized tube stiffness, CNC-machined head tube, heat-treated CrMo 4130 at the Brad Race ProS

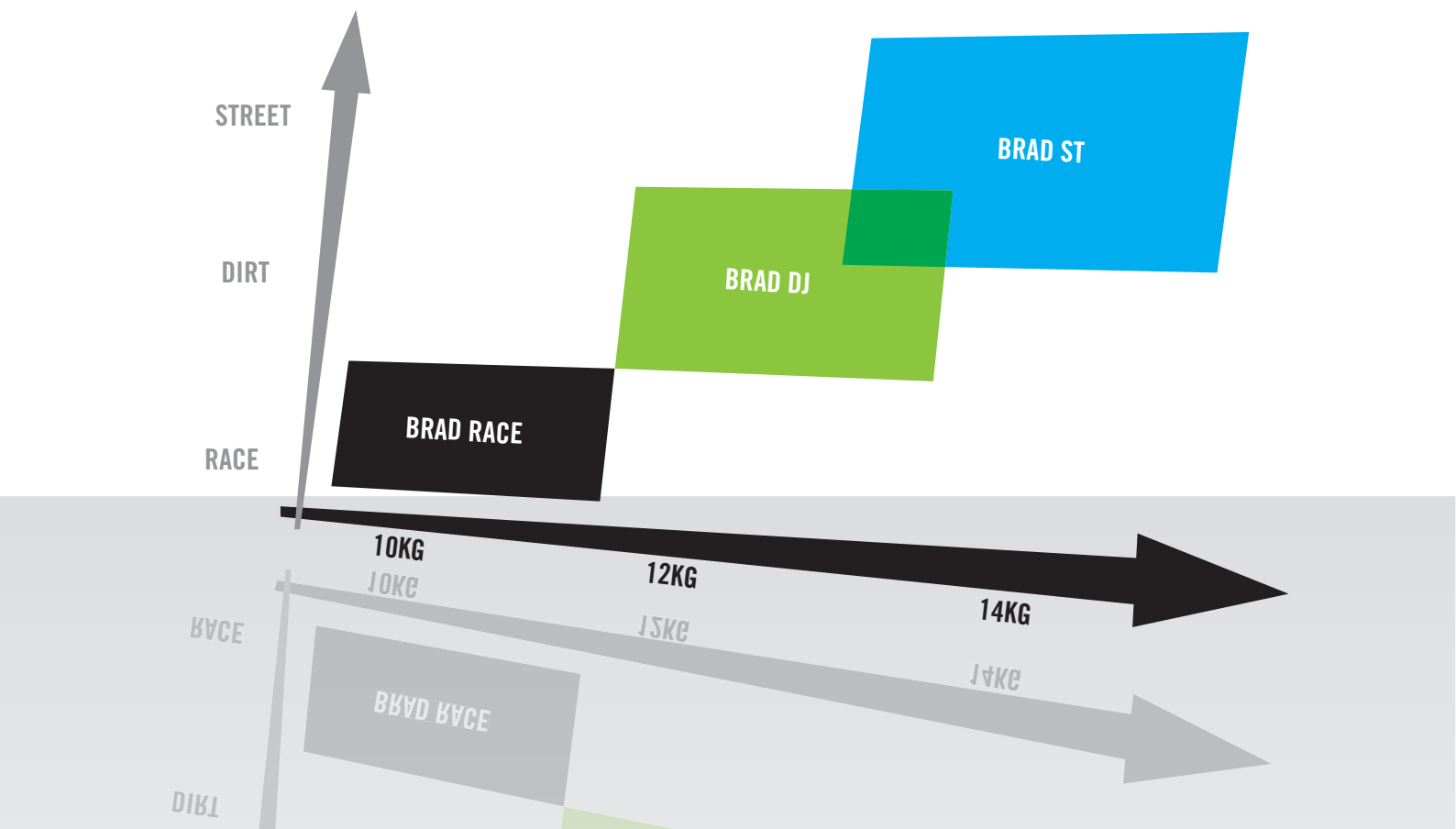

# BRAD RACE ProXL



4X  
BMX Race



## SPECIFICATIONS

FRAME	2010 Brad ProXL EuroBB
SIZE	ProXL (bis ca. 1,85m)
WEIGHT	9,1 kg
FRAMEWEIGHT	0
COLORCODE	blackmetallic (P12V)
TUBE	PG tube Extraction
PRODUCTION	TIG welding
MATERIAL	Alloy 6061
GO	Single speed
DROP-OUT	
SHOCK	
TRAVEL FRONT	
FORK	UMF Carbon Fork
TRAVEL FRONT	
BB SET	Samox AF15
BRAKE-LEVER	Tektro 319ACL/R
BRAKE-FRONT	U-Brake
BRAKE-REAR	Tektro BX-25 cartridge pads
CHAIN	KMC Z410
CHAINGUARD	
CHAINWHEEL	Samox AF15 44T 180mm
DERA-FRONT	
DERA-REAR	
FREEWHEEL	16T
GRIP	Velo VLG-411-1A
H-BAR	MJ CM W:700 R:200
H-B STEM	UMF L:50mm
HEAD SET	FSA BB410
HUB-FRONT	2x bearings
HUB-FRONT AXLE	3/8"
HUB-REAR	4x bearings
HUB-REAR AXLE	3/8"
WHEELSIZE	20"
PEDAL	BMX Pedal
RIM	Alex DM22
SADDLE	Velo VL-1125-1
SEAT CLAMP	UMF
SEAT POST	UMF ALLOY 25.4D/Carbon
SHIFTER-FRONT	
SHIFTER-REAR	
SPOKE	Stainless 2.0
TIRE-FRONT	Maxxis Hoodlum 2.0
TIRE-REAR	Maxxis Hoodlum 1.85
OTHER	

## GEOMETRY

FRAME SIZE		ProXL
FRAME LENGTH IN MM	CT	255
FRAME SIZE IN MM	AH	
TOP TUBE HORIZON IN MM	A	534
SEAT TUBE IN MM	C	250
DROP OUT INNER WIDTH		110
CHAIN STAYS IN MM	D	385
HEAD TUBE ANGLE	Q1	74
SEAT TUBE ANGLE	Q7	72
SEAT TUBE DIAMETER IN MM		25,4
BOTTOM BRACKET DROP IN MM	H	38
BOTTOM BRACKET WIDTH IN MM		68
WHEEL BASE IN MM	W	968
FORK OFFSET IN MM	F	25,4
HEAD TUBE LENGTH IN MM	L	100
STEERER DIAMETER IN INCH		1 1/8"
FORK LENGTH IN MM	G	326
ISCG		

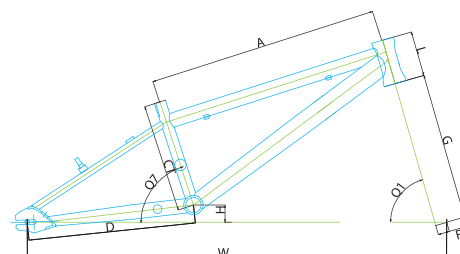

## NEWS BLOG

- New 2 piece Chainwheel - 970g with exterior bearing BB-Set

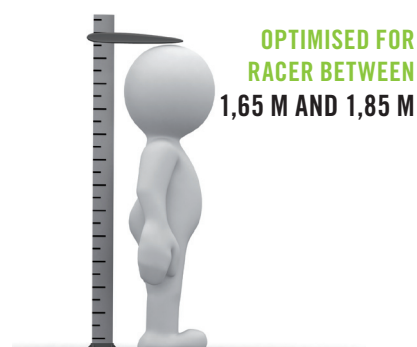



# BRAD RACE ProS



4X  
BMX Race



## SPECIFICATIONS

FRAME	2010 Brad ProS EuroBB
SIZE	ProS (bis ca. 1,65m)
WEIGHT	9,2 kg
FRAMEWEIGHT	0
COLORCODE	blackmetallic (P12V)
TUBE	PG tube Extraction
PRODUCTION	TIG welding
MATERIAL	Alloy 6061
GO	Single speed
DROP-OUT	
SHOCK	
TRAVEL FRONT	
FORK	CWI-1197 3/8" Cr-Mo
TRAVEL FRONT	
BB SET	ISIS
BRAKE-LEVER	Tektro 319ACL/R
BRAKE-FRONT	U-Brake
BRAKE-REAR	Tektro BX-310
CHAIN	KMC Z410
CHAINGUARD	
CHAINWHEEL	Samox AF15 42T 175mm
DERA-FRONT	
DERA-REAR	
FREEWHEEL	16T
GRIP	Velo VLG-411-1A
H-BAR	MJ CM W:640 R:165
H-B STEM	UMF L:50mm
HEAD SET	FSA No.10
HUB-FRONT	2x bearings
HUB-FRONT AXLE	3/8"
HUB-REAR	4x bearings
HUB-REAR AXLE	3/8"
WHEELSIZE	20"
PEDAL	BMX Pedal
RIM	Alex MUS32
SADDLE	Velo VL-1125-1
SEAT CLAMP	UMF
SEAT POST	UMF ALLOY 25.4D
SHIFTER-FRONT	
SHIFTER-REAR	
SPOKE	Stainless 2.0
TIRE-FRONT	Maxxis Hoodlum 2.0
TIRE-REAR	Maxxis Hoodlum 1.85
OTHER	

## GEOMETRY

FRAME SIZE		ProS
FRAME LENGTH IN MM	CT	240
FRAME SIZE IN MM	AH	
TOP TUBE HORIZON IN MM	A	510
SEAT TUBE IN MM	C	235
DROP OUT INNER WIDTH		110
CHAIN STAYS IN MM	D	370
HEAD TUBE ANGLE	Q1	74
SEAT TUBE ANGLE	Q7	72
SEAT TUBE DIAMETER IN MM		25,4
BOTTOM BRACKET DROP IN MM	H	38
BOTTOM BRACKET WIDTH IN MM		68
WHEEL BASE IN MM	W	929
FORK OFFSET IN MM	F	25,4
HEAD TUBE LENGTH IN MM	L	100
STEERER DIAMETER IN INCH		1 1/8"
FORK LENGTH IN MM	G	326
ISCG		

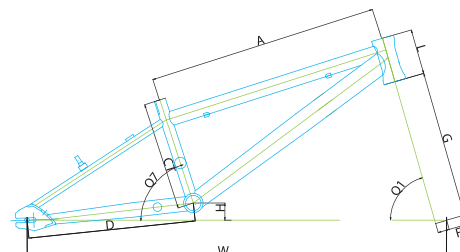

## NEWS BLOG

- New 3 piece chainwheel - 670g + 288g BB-Set
- New Fork CWI 1197 with 840 g, anti torsion optimised fork tubes, CNC steerer head treatment 4130 CrMo - 700g off then in 2010



OPTIMISED FOR  
RACER BETWEEN  
1,50 M AND 1,70 M

# BRAD RACE ExpS



4X  
BMX Race



## SPECIFICATIONS

FRAME	2010 Brad ExpS EuroBB
SIZE	Exp-Jun (bis ca. 1,50m)
WEIGHT	7,9 kg
FRAMEWEIGHT	0
COLORCODE	blackmetallic (P12V)
TUBE	PG tube Extraction
PRODUCTION	TIG welding
MATERIAL	Alloy 6061
GO	Single speed
DROP-OUT	
SHOCK	
TRAVEL FRONT	
FORK	UMF Aluminum Fork
TRAVEL FRONT	
BB SET	ISIS
BRAKE-LEVER	Tektro 319ACL/R
BRAKE-FRONT	U-Brake
BRAKE-REAR	Tektro 926AL
CHAIN	KMC Z410
CHAINGUARD	
CHAINWHEEL	Samox AF10 41T 160 mm
DERA-FRONT	
DERA-REAR	
FREEWHEEL	16T
GRIP	Velo VLG-411-1A
H-BAR	MJ ALLOY W:620 R:115
H-B STEM	UMF L:40mm
HEAD SET	FSA No.10
HUB-FRONT	2x bearings
HUB-FRONT AXLE	3/8"
HUB-REAR	4x bearings
HUB-REAR AXLE	3/8"
WHEELSIZE	20"
PEDAL	BMX Pedal
RIM	Alex VP-15
SADDLE	Velo w/integ. Seatpost
SEAT CLAMP	UMF
SEAT POST	UMF ALLOY 25.4D
SHIFTER-FRONT	
SHIFTER-REAR	
SPOKE	Stainless 2.0
TIRE-FRONT	CST C-714 20*1-3/8"
TIRE-REAR	CST C-714 20*1-3/8"
OTHER	

## GEOMETRY

FRAME SIZE		ExpS
FRAME LENGTH IN MM	CT	220
FRAME SIZE IN MM	AH	
TOP TUBE HORIZON IN MM	A	482
SEAT TUBE IN MM	C	220
DROP OUT INNER WIDTH		110
CHAIN STAYS IN MM	D	350
HEAD TUBE ANGLE	Q1	74
SEAT TUBE ANGLE	Q7	72
SEAT TUBE DIAMETER IN MM		22,2"
BOTTOM BRACKET DROP IN MM	H	25
BOTTOM BRACKET WIDTH IN MM		68
WHEEL BASE IN MM	W	875
FORK OFFSET IN MM	F	25,4
HEAD TUBE LENGTH IN MM	L	90
STEERER DIAMETER IN INCH		1 1/8"
FORK LENGTH IN MM	G	326
ISCG		

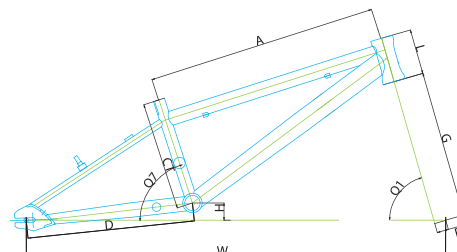

## NEWS BLOG



OPTIMISED FOR  
RACER BETWEEN  
1,40 M AND 1,55 M



# BRAD RACE JUN S



4X  
BMX Race



## SPECIFICATIONS

FRAME	2010 Brad JunS EuroBB
SIZE	Jun-Mini (bis ca. 1,40m)
WEIGHT	7,7 kg
FRAMEWEIGHT	0
COLORCODE	blackmetallic (P12V)
TUBE	PG tube Extraction
PRODUCTION	TIG welding
MATERIAL	Alloy 6061
GO	Single speed
DROP-OUT	
SHOCK	
TRAVEL FRONT	
FORK	UMF Aluminum Fork
TRAVEL FRONT	
BB SET	ISIS
BRAKE-LEVER	Tektro 319ACL/R
BRAKE-FRONT	U-Brake
BRAKE-REAR	Tektro 926AL
CHAIN	KMC Z410
CHAINGUARD	
CHAINWHEEL	Samox AF10 36T 150mm
DERA-FRONT	
DERA-REAR	
FREEWHEEL	14T
GRIP	Velo VLG-411-1A
H-BAR	MJ ALLOY W:620 R:115
H-B STEM	UMF L:40mm
HEAD SET	FSA No.10
HUB-FRONT	2x bearings
HUB-FRONT AXLE	3/8"
HUB-REAR	4x bearings
HUB-REAR AXLE	3/8"
WHEELSIZE	20"
PEDAL	BMX Pedal
RIM	Alex VP-15
SADDLE	Velo w/integ. Seatpost
SEAT CLAMP	UMF
SEAT POST	UMF ALLOY 25.4D
SHIFTER-FRONT	
SHIFTER-REAR	
SPOKE	Stainless 2.0
TIRE-FRONT	CST C-714 20*1-1/8"
TIRE-REAR	CST C-714 20*1-1/8"
OTHER	

## GEOMETRY

FRAME SIZE		JunS
FRAME LENGTH IN MM	CT	220
FRAME SIZE IN MM	AH	
TOP TUBE HORIZON IN MM	A	460
SEAT TUBE IN MM	C	220
DROP OUT INNER WIDTH		110
CHAIN STAYS IN MM	D	350
HEAD TUBE ANGLE	Q1	73
SEAT TUBE ANGLE	Q7	70
SEAT TUBE DIAMETER IN MM		22,2"
BOTTOM BRACKET DROP IN MM	H	25
BOTTOM BRACKET WIDTH IN MM		68
WHEEL BASE IN MM	W	852
FORK OFFSET IN MM	F	25,4
HEAD TUBE LENGTH IN MM	L	90
STEERER DIAMETER IN INCH		1 1/8"
FORK LENGTH IN MM	G	326
ISCG		

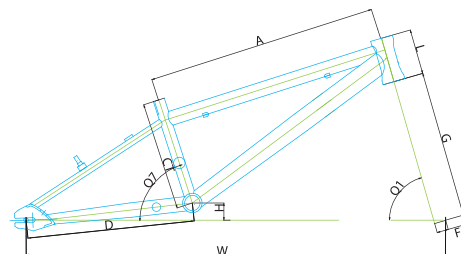

## NEWS BLOG



OPTIMISED FOR  
RACER UP TO  
1,40 M

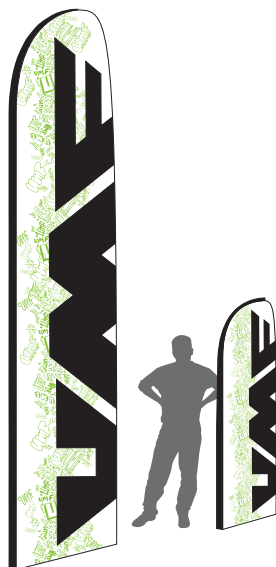

## UMF BEACH UND DECO FLAG

Beachflag: 5,5m mit Erdanker. Ideal für den Außeneinsatz  
Decoflag: 2 m mit Stahlfuß. Ideal für den Innenbereich oder zum Zustellen im Außenbereich.

ARTIKELNUMMER	BEZEICHNUNG	VERPACKUNG
147.99.010	Beachflag UMF	1 Flagge, 1 Rute, 1 Erdanker, 1 Transporttasche
147.99.011	Decoflag UMF	1 Flagge, 1 Rute, 1 Stahlfußplatte

Preis auf Anfrage



3000 x 1000mm



2000 x 800mm



1200 x 400 mm

## UMF BANNER

PVC Banner - wetterfest, geöst,

ARTIKELNUMMER	BEZEICHNUNG	GRÖSSE
147.99.007	Banner UMF	300x100 cm
47.99.007	Banner UMF	200x80 cm
47.99.007	Banner UMF	140x40 cm

Preis auf Anfrage

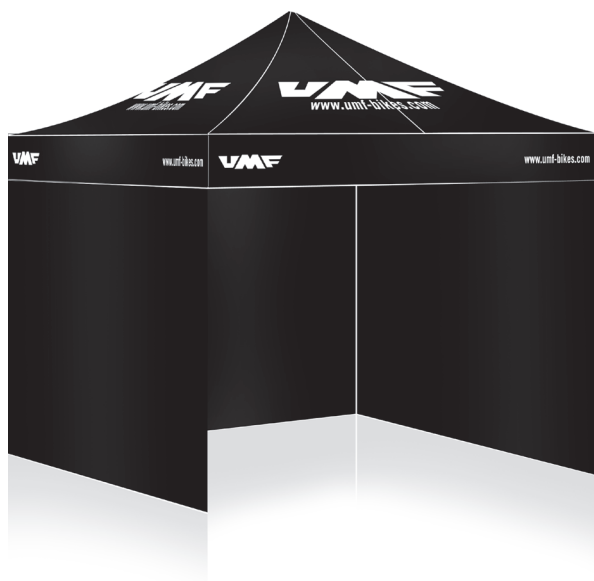

## UMF Zelt

3 x 4,5 Meter, Alugestell. Schnellbauzelt, Alu-Profil mit Scherenmechaniken  
Optimal für Veranstaltungen sowie für den Outdoor Ausstellungsbereich Ihres Shops.  
Das Zelt kommt inklusive einer Sporttasche mit Transporträdern.  
Je Zelt werden 4 Gewichte benötigt

ARTIKELNUMMER	BEZEICHNUNG
192.39.050	Zelt 3x4,5
192.39.062	Gewicht 5,5 kg

Preis auf Anfrage



## GRIFFE UMF JELLY

UMF bekennt Farbe - mit den super coolen Jelly Griffen bringt UMF Farbe an den Lenker. Der Fahrer hat die Wahl - wir bieten jeden Griff einzeln (nicht als Paar) an, somit kann sich der Fahrer seine gewünschte Farbkombination selbst zusammen stellen, z.B. links orange, rechts grün!

- der 3D Jelly-Look der Griffen sieht einfach cool aus
- doppelte Schraubsicherung
- stabile Endkappe aus robustem Kunststoff
- MIX IT (Griffe einzeln, nicht als Paar erhältlich)



ARTIKELNUMMER	BEZEICHNUNG	VERPACKUNG	FARBE
147.07.210	Griff Jelly	1 Griff	grau
147.07.211	Griff Jelly	1 Griff	weiß
147.07.212	Griff Jelly	1 Griff	orange
147.07.213	Griff Jelly	1 Griff	grün
147.07.214	Griff Jelly	1 Griff	blau
147.07.215	Griff Jelly	1 Griff	rot
147.07.216	Griff Jelly	1 Griff	schwarz
147.07.217	Griff Jelly	1 Griff	gelb
147.07.218	Griff Jelly	1 Griff	lila
147.07.219	Griff Jelly	1 Griff	rosa
147.07.240	Griff Jelly	1 Griff	braun
147.07.241	Griff Jelly	1 Griff	Glitter Gold
147.07.242	Griff Jelly	1 Griff	Glitter Rot
147.07.243	Griff Jelly	1 Griff	Glitter Blau
147.07.244	Griff Jelly	1 Griff	Transparent

## MORTOP JELLY GRIFF DISPLAY

Der Eye-Catcher am Point of Sale. Das schicke Erdbeerkörbchen mit einer Auswahl der neuen Mortop Jelly Griffen wird das Highlight in Ihrem Shop! Das Display beinhaltet 16 verschiedenfarbige Mortop Jelly Griffen.



ARTIKELNUMMER	BEZEICHNUNG	VERPACKUNG
147.07.291	Mortop Jelly Griff Display	16 Griffen gemischt



## KLEMMRING JELLY GRIFF

Und wir treiben es noch bunter – passend zu den neuen UMF Mortop Jelly Griffen gibt es die Klemmringe in bunt eloxierten Farben zum Austauschen und Ergänzen. Für den individuellsten Griff, den es je gab!

ARTIKELNUMMER	BEZEICHNUNG	VERPACKUNG	FARBE
147.07.220	Klemmring Jelly	1 Stk.	gold
147.07.221	Klemmring Jelly	1 Stk.	rot
147.07.222	Klemmring Jelly	1 Stk.	orange
147.07.223	Klemmring Jelly	1 Stk.	blau
147.07.224	Klemmring Jelly	1 Stk.	grün
147.07.225	Klemmring Jelly	1 Stk.	lila
147.07.226	Klemmring Jelly	1 Stk.	weiß
147.07.227	Klemmring Jelly	1 Stk.	silber
147.07.228	Klemmring Jelly	1 Stk.	braun
147.07.229	Klemmring Jelly	1 Stk.	türkis



## VORBAU UMF H-STEM

Der UMF H-STEM für Freeride und Dirt. Durch einen einzigartigen Klemmmechanismus hat der Vorbau keine herausstehenden Schrauben oder scharfe Kanten und sorgt für cleane und hochwertige Optik am Bike. Inkl. Reduzierhülse von 31.8 auf 22.2 mm. Länge: 50 mm  
NEU: Variationen mit eloxierten Inlays

ARTIKELNUMMER	BEZEICHNUNG	GEWICHT	FARBE	INLAY
147.07.120	Vorbau	245 g	schwarz	schwarz
147.07.121	Vorbau	245 g	schwarz	rot
147.07.122	Vorbau	245 g	schwarz	grün
147.07.123	Vorbau	245 g	schwarz	blau
147.07.124	Vorbau	245 g	schwarz	orange







### SATTEL UMF BLACK'N'WHITE PIVOTAL

Sattel von UMF mit neuem Pivotal Standard; ideal für BMX und Dirt; passend für UMF Kubby Stick Sattelstützen (147.07.303 – .305)

ARTIKELNUMMER	BEZEICHNUNG	VERPACKUNG	FARBE
147.07.607	Sattel UMF black'n'white Pivotal Sattel passend für Knubby Stick	1 Stk.	schwarz/weiß



### SATTEL LITTLE CHECKERED

Der Little Checkerd ist das Leichtgewicht unter den Checkered Sätteln; ideal für minimalistische Dirtbiker und BMXer, die hohen Wert auf Robustheit und geringes Gewicht legen.

ARTIKELNUMMER	BEZEICHNUNG	VERPACKUNG	FARBE	GRÖSSEN
147.07.605	UMF Little Checkered mit weißem Gestell	1 Stk.	grün	8 mm
147.07.606	UMF Little Checkered mit weißem Gestell	1 Stk.	orange	8 mm



## UMF/ALPINA DH HELMET

UMF entwickelt zusammen mit dem renommierten Helmhersteller Alpina einen neuen DH Helm. Die ersten Muster werden voraussichtlich bei der Eurobike 2010 in Friedrichshafen vorgestellt. Mehr Infos erhalten in diesem Winter Sie unter [www.umf-bikes.com](http://www.umf-bikes.com) sowie unter [www.mcg-parts.de](http://www.mcg-parts.de)

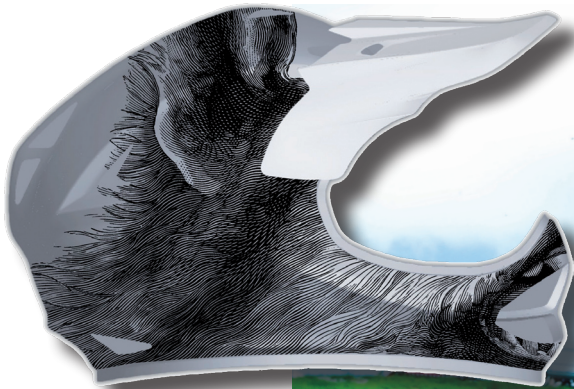



## ZWEI NEUE UMF HELME "HANDMADE TEAM" UND "NIGHTMADE", MADE BY ALPINA!

Alpina Airtime Schale, Eurobike Design Award Gewinner 2008  
InMold Technologie, 6 Airflow Öffnungen, CE EN 1078 konform,  
In den Größen S/M (52-57cm) und L/XL (57-61 cm) erhältlich, Gewicht: 270g

### OHNE Runsystem

ARTIKELNUMMER	BEZEICHNUNG	FARBE
14731000	Helm UMF /Alpina Airtime Handmade Team Gr. S/M	grün
14731001	Helm UMF /Alpina Airtime Handmade Team Gr. L/XL	grün
14731002	Helm UMF /Alpina Airtime Nightmade Gr. S/M	schwarz
14731003	Helm UMF /Alpina Airtime Nightmade Gr. L/XL	schwarz

Ihr Preis:

### MIT Runsystem

ARTIKELNUMMER	BEZEICHNUNG	FARBE
14731004	Helm UMF /Alpina Airtime Handmade Team Gr. S/M	grün
14731005	Helm UMF /Alpina Airtime Handmade Team Gr. L/XL	grün
14731006	Helm UMF /Alpina Airtime Nightmade Gr. S/M	schwarz
14731007	Helm UMF /Alpina Airtime Nightmade Gr. L/XL	schwarz

Ihr Preis:

## SATTELSTÜTZE KNUBBY STICK

UMF bietet nun Sattelstützen und Sättel mit Pivotal- Aufnahme an - dem neuen Standard für BMX und Dirt. Die direkte Verschraubung des Sattels mit der Stütze steigert die Robustheit der kompletten Einheit bei Stürzen. Es ist kein Gestell mehr vorhanden, welches verbogen werden oder brechen kann. In drei Größen erhältlich: Ø 25.4, 27.2 oder 31.6 mm

ARTIKELNUMMER	BEZEICHNUNG	VERPACKUNG	FARBE	GRÖSSEN
147.07.303	Pivotal Knubby Stick Ø 25.4 mm	1 Stk.	schwarz	120 mm
147.07.304	Pivotal Knubby Stick Ø 27.2 mm	1 Stk.	schwarz	320 mm
147.07.305	Pivotal Knubby Stick Ø 31.6 mm;	1 Stk.	schwarz	320 mm

Ihr Preis:

## SATTELSTÜTZE UMF

Die UMF Sattelstütze erlaubt auch sehr steile Stellungen des Sattels, dank der um 360° verdrehbaren Sattelklemmung. Aus AL6061-T6. Schwarz eloxiert mit UMF-Laserlogo. In Ø 25.4 mm, Ø 27.2 mm und jetzt auch in Ø 31.6 mm erhältlich.

ARTIKELNUMMER	BEZEICHNUNG	VERPACKUNG	GEWICHT	FARBE	GRÖSSEN
147.07.306	Sattelstütze UMF Ø 25.4 mm	1 Stk.	290 g	schwarz	300 mm
147.07.307	Sattelstütze UMF Ø 27.2 mm	1 Stk.	290 g	schwarz	300 mm
147.07.308	Sattelstütze UMF Ø 31.6 mm	1 Stk.	290 g	schwarz	300 mm

Ihr Preis:

## PEDALE UMF FR PRO

Die FR Pro Pedale haben einen besonders flachen Körper, was die Fahreigenschaften erheblich verbessert. Dank der verschraubten Pins bieten die Pedale hervorragenden Grip.

- lasergraviertes UMF Logo
- mit hochwertigen Industrielagern
- in schwarz und weiß erhältlich

ARTIKELNUMMER	BEZEICHNUNG	VERPACKUNG	FARBE
147.07.502	Pedale UMF FR Pro	1 Paar	schwarz
147.07.503	Pedale UMF FR Pro	1 Paar	weiß

Ihr Preis:

## PEDALE UMF FR COMP

Günstige Plattformpedale für den Einsteiger und preisbewussten Freerider.

- in schwarz und weiß erhältlich
- kugellagert
- geschmiedeter Körper und Pins

ARTIKELNUMMER	BEZEICHNUNG	VERPACKUNG	FARBE
147.07.504	Pedale UMF FR Comp	1 Paar	schwarz
147.07.505	Pedale UMF FR Comp	1 Paar	weiß

Ihr Preis:







## SNEAKERS UMF

Die gefragten UMF Schuhe in drei neuen Farbkombinationen. Mit spezieller Sohle, ideal zum Dirlen & BMX fahren – nicht zu weich, nicht zu hart.

ARTIKELNUMMER	BEZEICHNUNG	FARBE	GRÖSSEN
191.31.082	Sneakers UMF checkered brownly	braun / weiß	Gr. 39
191.31.083	Sneakers UMF checkered brownly	braun / weiß	Gr. 40
191.31.084	Sneakers UMF checkered brownly	braun / weiß	Gr. 41
191.31.085	Sneakers UMF checkered brownly	braun / weiß	Gr. 42
191.31.086	Sneakers UMF checkered brownly	braun / weiß	Gr. 43
191.31.087	Sneakers UMF checkered brownly	braun / weiß	Gr. 44
191.31.088	Sneakers UMF checkered brownly	braun / weiß	Gr. 45
191.31.089	Sneakers UMF checkered brownly	braun / weiß	Gr. 46
191.31.060	Sneakers UMF checkered Team	grün / weiß	Gr. 37
191.31.061	Sneakers UMF checkered Team	grün / weiß	Gr. 38
191.31.062	Sneakers UMF checkered Team	grün / weiß	Gr. 39
191.31.063	Sneakers UMF checkered Team	grün / weiß	Gr. 40
191.31.064	Sneakers UMF checkered Team	grün / weiß	Gr. 41
191.31.065	Sneakers UMF checkered Team	grün / weiß	Gr. 42
191.31.066	Sneakers UMF checkered Team	grün / weiß	Gr. 43
191.31.067	Sneakers UMF checkered Team	grün / weiß	Gr. 44
191.31.068	Sneakers UMF checkered Team	grün / weiß	Gr. 45
191.31.069	Sneakers UMF checkered Team	grün / weiß	Gr. 46
191.31.072	Sneakers UMF checkered not dark	schwarz/weiß	Gr. 39
191.31.073	Sneakers UMF checkered not dark	schwarz/weiß	Gr. 40
191.31.074	Sneakers UMF checkered not dark	schwarz/weiß	Gr. 41
191.31.075	Sneakers UMF checkered not dark	schwarz/weiß	Gr. 42
191.31.076	Sneakers UMF checkered not dark	schwarz/weiß	Gr. 43
191.31.077	Sneakers UMF checkered not dark	schwarz/weiß	Gr. 44
191.31.078	Sneakers UMF checkered not dark	schwarz/weiß	Gr. 45
191.31.079	Sneakers UMF checkered not dark	schwarz/weiß	Gr. 46

Ihr Preis:

## UMF MERCH



### T-SHIRT UMF TEAM-EDITION WEISS

Weißes T-Shirt mit klassischem Schnitt und verstärkter Schulternaht.

Mit „FOR YOUR NEXT DIRTY WEEKEND“ – Druck auf der Brust und UMF Logo auf der Rückseite.

Material: 95% Baumwolle / 5% Elasthan

ARTIKELNUMMER	BEZEICHNUNG	FARBE	GRÖSSEN /
192.30.400	T-Shirt UMF Team-Edition	weiß	S
192.30.401	T-Shirt UMF Team-Edition	weiß	M
192.30.402	T-Shirt UMF Team-Edition	weiß	L
192.30.403	T-Shirt UMF Team-Edition	weiß	XL

Ihr Preis:



### T-SHIRT UMF SCHWARZ

Schwarzes T-Shirt mit klassischem Schnitt und verstärkter Schulternaht.

Mit „FOR YOUR NEXT DIRTY WEEKEND“ – Druck auf der Brust und UMF Logo auf der Rückseite.

Material: 95% Baumwolle / 5% Elasthan

ARTIKELNUMMER	BEZEICHNUNG	FARBE	GRÖSSEN
192.30.405	T-Shirt UMF „FOR YOUR NEXT DIRTY WEEK-END“	schwarz	S
192.30.406		schwarz	M
192.30.407		schwarz	L
192.30.408		schwarz	XL
192.30.409		schwarz	XXL

Ihr Preis:

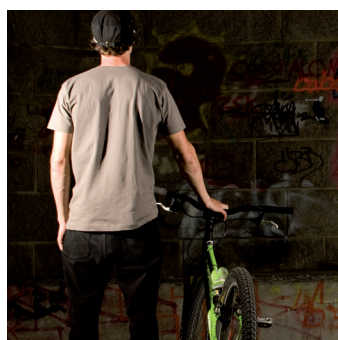

### T-SHIRT UMF ANTS GRAU

Graues T-Shirt mit klassischem Schnitt und verstärkter Schulternaht.

Mit UMF Logo Motiv „ANTS“ auf der Brust. Material: 95% Baumwolle / 5% Elasthan

ARTIKELNUMMER	BEZEICHNUNG	FARBE	GRÖSSEN	VK
192.30.410	T-Shirt UMF „ANTS“	grau	S	
192.30.411	T-Shirt UMF „ANTS“	grau	M	
192.30.412	T-Shirt UMF „ANTS“	grau	L	
192.30.413	T-Shirt UMF „ANTS“	grau	XL	
192.30.414	T-Shirt UMF „ANTS“	grau	XXL	

Ihr Preis:





## T-SHIRT UMF LADY ANTS SCHWARZ

Tailliertes Lady-Shirt, ärmellos in schwarz. Mit weißem UMF Logo Motiv „ANTS“ auf der Brust.  
Material: 100% Baumwolle

ARTIKELNUMMER	BEZEICHNUNG	FARBE	GRÖSSEN
192.30.415	T-Shirt UMF Lady „ANTS“	schwarz	S
192.30.416	T-Shirt UMF Lady „ANTS“	schwarz	M
192.30.417	T-Shirt UMF Lady „ANTS“	schwarz	L

Ihr Preis:



## T-SHIRT UMF LADY HOODIE GELB

Ärmellos mit „FOR YOUR NEXT DIRTY WEEKEND“ - Druck und UMF Logo auf Rücken  
Material: 100% Baumwolle; 145 g

ARTIKELNUMMER	BEZEICHNUNG	FARBE	GRÖSSEN
192.30.420	T-Shirt UMF Lady Hoodie „ANTS“	gelb	S
192.30.421	T-Shirt UMF Lady Hoodie „ANTS“	gelb	M
192.30.422	T-Shirt UMF Lady Hoodie „ANTS“	gelb	L

Ihr Preis:

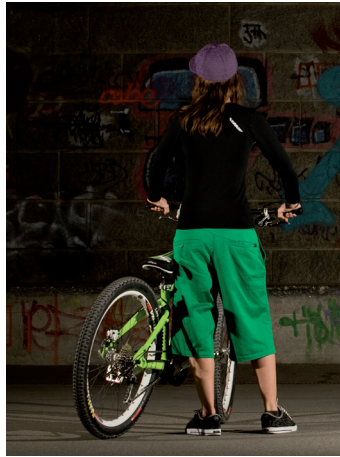

## LONGSLEEVE UMF GENTS SCHWARZ

Stylisches Longsleeve mit anliegender Passform. Schwarz mit Motiv „GINO“ auf Brust und UMF Logo in gelb. Material: 95% Baumwolle / 5% Elasthan; 200g

Artikelnummer	Bezeichnung	Farbe	Größen
192.30.425	Longsleeve UMF „GINO“	schwarz	S
192.30.426	Longsleeve UMF „GINO“	schwarz	M
192.30.427	Longsleeve UMF „GINO“	schwarz	L
192.30.428	Longsleeve UMF „GINO“	schwarz	XL

Ihr Preis:

## LONGSLEEVE UMF LADY SCHWARZ

Stylisches Longsleeve mit anliegender Passform. Schwarz mit Motiv „GINA“ auf Brust und UMF Logo in weiß. Material: 95% Baumwolle / 5% Elasthan; 200 g

Artikelnummer	Bezeichnung	Farbe	Größen
192.30.430	Longsleeve UMF Lady „GINA“	schwarz	S
192.30.431	Longsleeve UMF Lady „GINA“	schwarz	M
192.30.432	Longsleeve UMF Lady „GINA“	schwarz	L

Ihr Preis:



## SWEATER UMF GENTS HOODIE

Weißer Sweater mit „Ameisenstraße“ und UMF Logo in schwarz auf dem Rücken; mit Bauchtasche  
Material: 80% Baumwolle / 20% Polyester

ARTIKELNUMMER	BEZEICHNUNG	FARBE	GRÖSSEN
192.30.435	Sweater Gents Hoodie	weiß	S
192.30.436	Sweater Gents Hoodie	weiß	M
192.30.437	Sweater Gents Hoodie	weiß	L
192.30.438	Sweater Gents Hoodie	weiß	XL

Ihr Preis:

## SWEATER UMF LADY HOODIE TÜRKIS

Türkisfarbener Sweater mit „Ameisenstraße“ und UMF Logo in schwarz auf dem Rücken; mit Bauchtasche Material: 80% Baumwolle / 20% Polyester

ARTIKELNUMMER	BEZEICHNUNG	FARBE	GRÖSSEN
192.30.440	Sweater Lady Hoodie	türkis	S
192.30.441	Sweater Lady Hoodie	türkis	M
192.30.442	Sweater Lady Hoodie	türkis	L

Ihr Preis:



## JACKE UMF GENTS HOODIE BRAUN

Braun mit „FOR YOUR NEXT DIRTY WEEKEND“ - Druck und UMF Logo auf Rücken in grün; mit Bauchtasche Material: 80% Baumwolle / 20% Polyester; 320g

ARTIKELNUMMER	BEZEICHNUNG	FARBE	GRÖSSEN
192.30.445	Jacke Gents	braun	S
192.30.446	Jacke Gents	braun	M
192.30.447	Jacke Gents	braun	L
192.30.448	Jacke Gents	braun	XL

Ihr Preis:

## JACKE UMF LADY HOODIE HELLBLAU

Hell-blau mit „FOR YOUR NEXT DIRTY WEEKEND“ - Druck und UMF Logo auf Rücken in rot; mit Bauchtasche Material: 80% Baumwolle / 20% Polyester; 320g

ARTIKELNUMMER	BEZEICHNUNG	FARBE	GRÖSSEN
192.30.450	Jacke Lady	hell-blau	S
192.30.451	Jacke Lady	hell-blau	M
192.30.452	Jacke Lady	hell-blau	L

Ihr Preis: